



Split level flat with an array of unique features

Churchfield Road, Chiswick, London W3 6BH

2 bedrooms • reception room • kitchen • bathroom • 90.8 sq m (977 sq ft)

Local information

Churchfield Road is situated in the heart of Acton and is famous locally for its boutique shops, bars and restaurants. For the commuter Acton offers fantastic tube station options with services including the District, Piccadilly and Central lines. Acton Central offers London Overground services, and there are also numerous bus routes available. The M4 is also easily accessible provides speedy access to Heathrow and the west.

About this property

The flat features its own front door, and upon entry you are greeted with a lovely hallway with high ceilings and stairs up to the rest of the flat. The main reception room features wooden floorboards, high ceilings, an ornate fireplace and two separate windows which allow an abundance of natural light to seep in, making for a superb entertaining space. Adjacent to this is a modern kitchen with a good sized dining area, with a range of appliances and some good storage space. There is also a bathroom with a shower. The second floor comprises two large double bedrooms which also benefit from a wealth of natural light and views.

Churchfield Road,, Chiswick, London W3 6BH



savills.co.uk

Savills Chiswick
020 8987 5550
chiswick@savills.com

Churchfield Road, W3

Approximate Gross Internal Area 90.8 sq m / 977 sq ft

For identification only. Not to scale.
© Mays Floorplans Ltd



Ground Floor

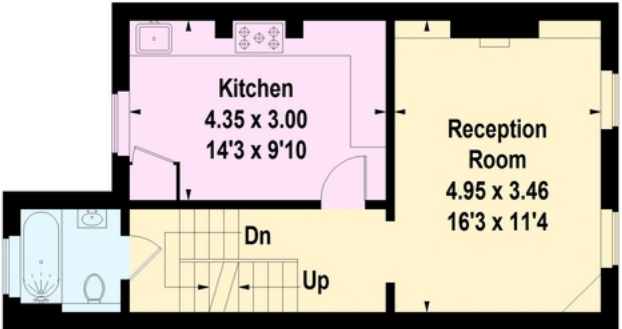

First Floor

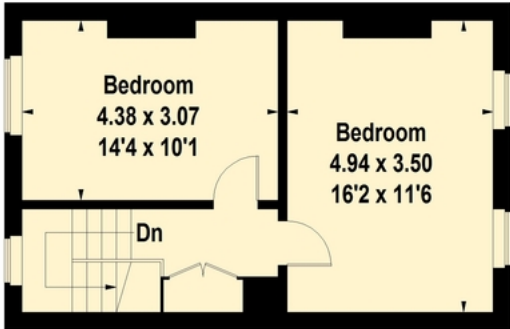

Second Floor

| Energy Efficiency Rating | | |
|---------------------------------------------|---------|-----------|
| | Current | Potential |
| Very energy efficient - lower running costs | | |
| (92-100) A | | |
| (81-91) B | | |
| (69-80) C | | |
| (55-68) D | | |
| (39-54) E | | |
| (21-38) F | | |
| (1-20) G | | |
| Not energy efficient - higher running costs | | |
| England, Scotland & Wales | 74 | 75 |
| EU Directive 2002/91/EC | | |

Important notice: Savills, their clients and any joint agents give notice that 1: They are not authorised to make or give any representations or warranties in relation to the property either here or elsewhere, either on their own behalf or on behalf of their client or otherwise. They assume no responsibility for any statement that may be made in these particulars. These particulars do not form part of any offer or contract and must not be relied upon as statements or representations of fact. 2: Any areas, measurements or distances are approximate. The text, photographs and plans are for guidance only and are not necessarily comprehensive. It should not be assumed that the property has all necessary planning, building regulation or other consents and Savills have not tested any services, equipment or facilities. Purchasers must satisfy themselves by inspection or otherwise. 91026071 Job ID: 133267 User Initials: HT

