

# Harberson Road, London SW12



## A STUNNING ARCHITECT DESIGNED FOUR BEDROOM HOUSE IN THE HEART OF BALHAM.

This fantastic stylishly restored house is spread over three floors and oozes contemporary charm and industrial chic. To the front is an elegant double reception room with the rear being used as a dining room. The double bay window with plantation shutters floods the room with an abundance of light. To the rear of the property is the bespoke Bulthap kitchen, boasting a range of Gaggenau appliances. The modern stainless steel central island which doubles as a breakfast bar houses an induction hob and extensive storage. To the right is a stunning exposed brick wall which gives a contemporary feel to the room, the opposite wall offers a wealth of storage. The kitchen is finished with polished concrete flooring and has under floor heating. To the rear are bi-folding doors giving access to the landscaped south facing patio garden. On this floor there is a utility room and cloakroom.

The first floor comprises three bedrooms and a spacious family bathroom fitted with fashionable coloured tiles. The converted loft on the third floor is occupied by the spacious master bedroom. There is a double walk in shower room on this floor fitted with Vola taps and a panoramic rooflight which is electronically controlled.



Harberson Road is situated in the heart of Balham and located a short walk from Balham underground and mainline railway station and the local amenities of Balham High Road. The property is also within walking distance of both Clapham Common and Tooting Bec Common. The house is moments from Hildreth Street market with its selection of trendy coffee bars and restaurants.

#### ACCOMMODATION

Double reception room ♦ Designer kitchen ♦ Four bedrooms ♦ Family bathroom ♦ Double shower room ♦ Additional W.C ♦ Utility room ♦ Garden ♦ EPC=E

London Borough of Wandsworth  
Freehold

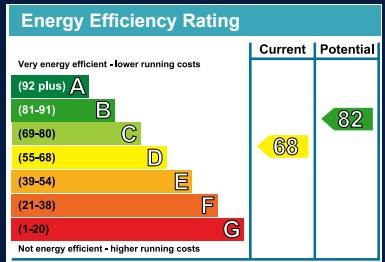
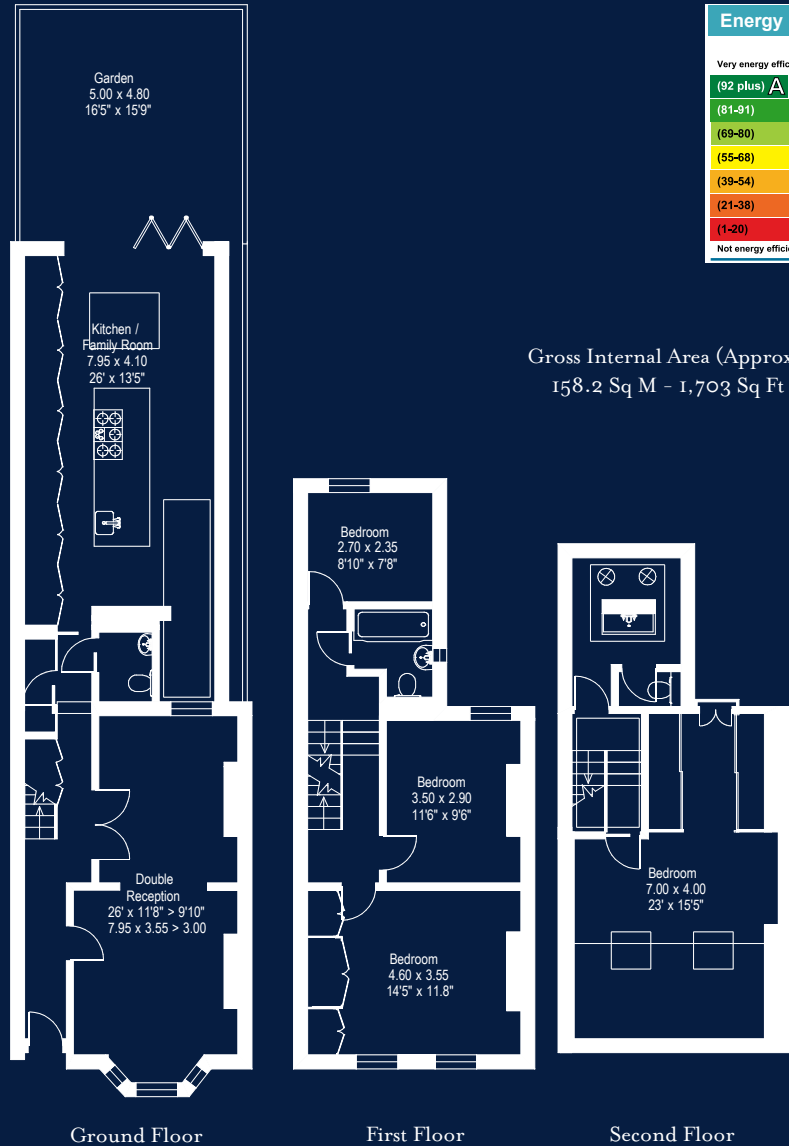

Gross Internal Area (Approx.)  
158.2 Sq M - 1,703 Sq Ft

onTheMarket.com



Viewing: Strictly by appointment with Savills.

Important notice  
Savills, their clients and any joint agents give notice that: 1: They are not authorised to make or give any representations or warranties in relation to the property either here or elsewhere, either on their own behalf or on behalf of their client or otherwise. They assume no responsibility for any statement that may be made in these particulars. These particulars do not form part of any offer or contract and must not be relied upon as statements or representations of fact. 2: Any areas, measurements or distances are approximate. The text, photographs and plans are for guidance only and are not necessarily comprehensive. It should not be assumed that the property has all necessary planning, building regulation or other consents and Savills have not tested any services, equipment or facilities. Purchasers must satisfy themselves by inspection or otherwise. 19/06/23 SB Brochure by Caktus Limited.

Savills Clapham  
020 8673 4111  
Savills Northcote Road  
020 3428 2222  
Savills Wandsworth  
020 8877 1222  
savills.co.uk

savills