



# Exceptional penthouse in the heart of Holborn

**Pinks Mews, 1-6 Dyer's Building, London, EC1N**

£1,150 pw (£4,983.33 pcm) plus fees apply, Furnished  
Available now





Duplex penthouse • Interior designed • Terraces • Concierge •  
Exceptional location

#### Local Information

Pinks Mews at Dyers Buildings is a secluded development in the heart of Holborn. Tucked away, in a gated environment, offering a rare tranquil retreat from the bustling capital city, stands six beautiful Victorian buildings set around a central courtyard. With private entrances, dedicated lifts and a 24-hour concierge, the development follows a design vision and specification unheard of outside Mayfair, Knightsbridge and Belgravia. Pinks Mews is surrounded by a multitude of amenities; first-class restaurants, luxury hotels and boutique designers are all within walking distance of the Mews, including: Roka, Brasserie Blanc, The Rosewood Hotel, Charles Tyrwhitt, and Arlington and Co. This mews is in a primary location, with underground stations within close proximity, Chancery Lane Station (0.1 miles – Central line), Farringdon Station (Thameslink, Circle, Hammersmith & City and Metropolitan lines), and Holborn Station (0.5 miles – Central and Piccadilly lines).

#### About this property

A stunning duplex 2 bedroom penthouse to rent features an open plan living space, 2 double bedrooms 2 bathrooms and a w/c. The expansive, dual-aspect, open-plan living area offers a bright and spacious area, perfect for entertaining. The bespoke kitchen suite boasts top of the range Miele integrated appliances. Natural, engineered oak flooring runs throughout this impressive space. The interiors are contemporary in design with bespoke fitted wardrobes and finished with beautiful bronze ironmongery and luxurious carpets. Both bedrooms boast beautiful en-suites with a walk-in shower and feature polished nickel taps and underfloor heating for the ultimate luxury experience. The apartment has been interior designed with high-end, luxury, furniture throughout. The property also benefits from two large terraces accessible via each bedroom.

#### Furnishing

Furnished

#### Local Authority

City of London

#### Energy Performance

EPC Rating = B

#### Viewing

All viewings will be accompanied and are strictly by prior arrangement through Savills Clerkenwell Lettings Office.

Telephone: +44 (0) 20 7253 2533.









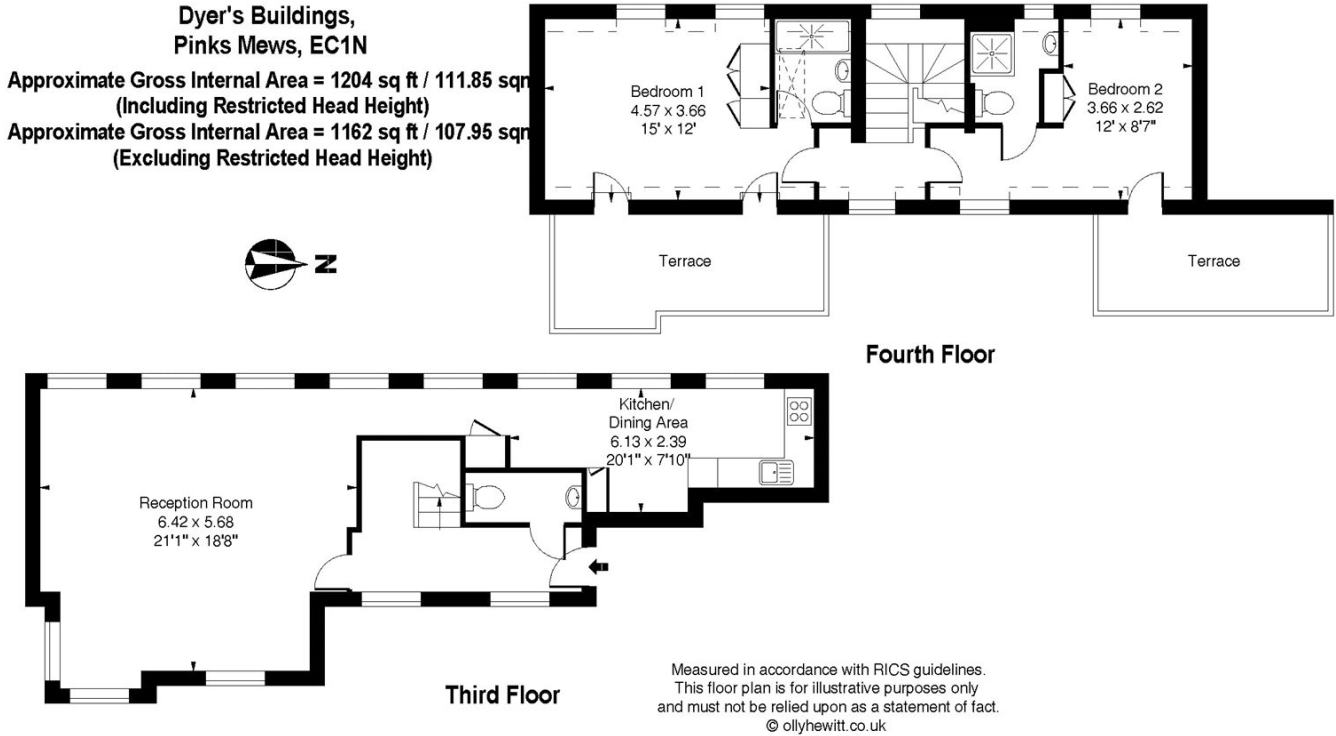

Pinks Mews, 1-6 Dyer's Building, London, EC1N  
Gross Internal Area 1204 sq ft, 111.85 m<sup>2</sup>

**Tristan Hickman**  
Clerkenwell Lettings  
**+44 (0) 20 7253 2533**  
tristan.hickman@savills.com



Energy Efficiency Rating		
	Current	Potential
Very energy efficient - lower running costs		
(92+) <b>A</b>		
(81-91) <b>B</b>		
(69-80) <b>C</b>	81	81
(55-68) <b>D</b>		
(39-54) <b>E</b>		
(21-38) <b>F</b>		
(1-20) <b>G</b>		
Not energy efficient - higher running costs		
England, Scotland & Wales	EU Directive 2002/91/EC 	

**Important notice** Savills, their clients and any joint agents give notice that: 1. They are not authorised to make or give any representations or warranties in relation to the property either here or elsewhere, either on their own behalf or on behalf of their client or otherwise. They assume no responsibility for any statement that may be made in these particulars. These particulars do not form part of any offer or contract and must not be relied upon as statements or representations of fact. 2. Any areas, measurements or distances are approximate. The text, images and plans are for guidance only and are not necessarily comprehensive. It should not be assumed that the property has all necessary planning, building regulation or other consents and Savills have not tested any services, equipment or facilities. Prospective tenants must satisfy themselves by inspection or otherwise. Please note that the local area may be affected by aircraft noise, you should make your own enquiries regarding any noise within the area before you make any offer.

\*There are different rules and fees for different tenancy types. For details of our fees and charges to go to Savills.co.uk/tenant-fees. For more detailed information read our applicant guide at savills.co.uk/applicant-guide.  
Hard copy available on request. . 20200109CLO

