



A stunning penthouse located in the popular Barts Square

Bartholomew Close, London, EC1A

£1,600 pw (£6,933.33 pcm) plus fees apply, Furnished, Part Furnished, Unfurnished
Available from 17.12.2021



- Great location
- Amazing outside space
- 3 Bedrooms
- Great residents facilities
- Recently built

Local Information

Barts Square is a short walk from the heart of the City. It sits on a long-established route between the Smithfield Conservation Area and St Paul's, linking London's historic heart with its financial centre.

About this property

A stunning penthouse located in the popular Barts Square development benefitting from an expansive open plan reception room with a luxury fully fitted kitchen, engineered oak flooring, large floor to ceiling windows which open out onto a 791 sqft wrap around private terrace with panoramic rooftop and City views. The property features three double bedrooms with built in wardrobes and two modern bathrooms (2 en-suite) and one WC all with contrasting marble finishes. The principal bedroom has a walk-through dressing area with fitted cupboards and an en-suite bathroom with a freestanding egg shaped bath and large separate shower. The second and third bedrooms at both double rooms and feature fitted wardrobes. The third bedroom is current set up as a home office.

Furnished to an exceptional standard the apartment offers top of the range appliances and fittings with intelligent building automation system for heating, cooling, motorised blinds and lighting. Secure underground parking is available by separate negotiation.

Residents of Fenwick House will have exclusive use of a range of on-site facilities including but not limited to five-star 24 hour concierge service, private meeting room, cinema with lounge bar, and a resident's lounge overlooking the communal garden.

Furnishing

Furnished, Part Furnished, Unfurnished

Local Authority

City Of London
Council Tax Band = G

Energy Performance

EPC Rating = B

Viewing

All viewings will be accompanied and are strictly by prior arrangement through Savills Clerkenwell Lettings Office.

Telephone: +44 (0) 20 7253 2533.



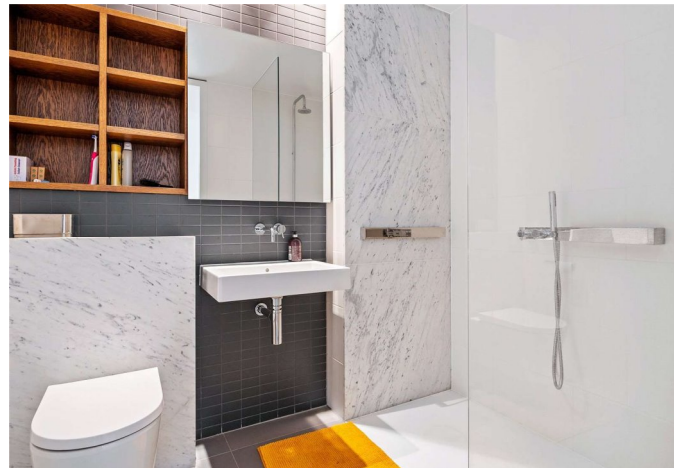

Bartholomew Close, London, EC1A
Gross Internal Area 1446 sq ft, 134.3 m²

Hannah Reason
Clerkenwell Lettings
+44 (0) 20 7253 2533
hannah.reason@savills.com

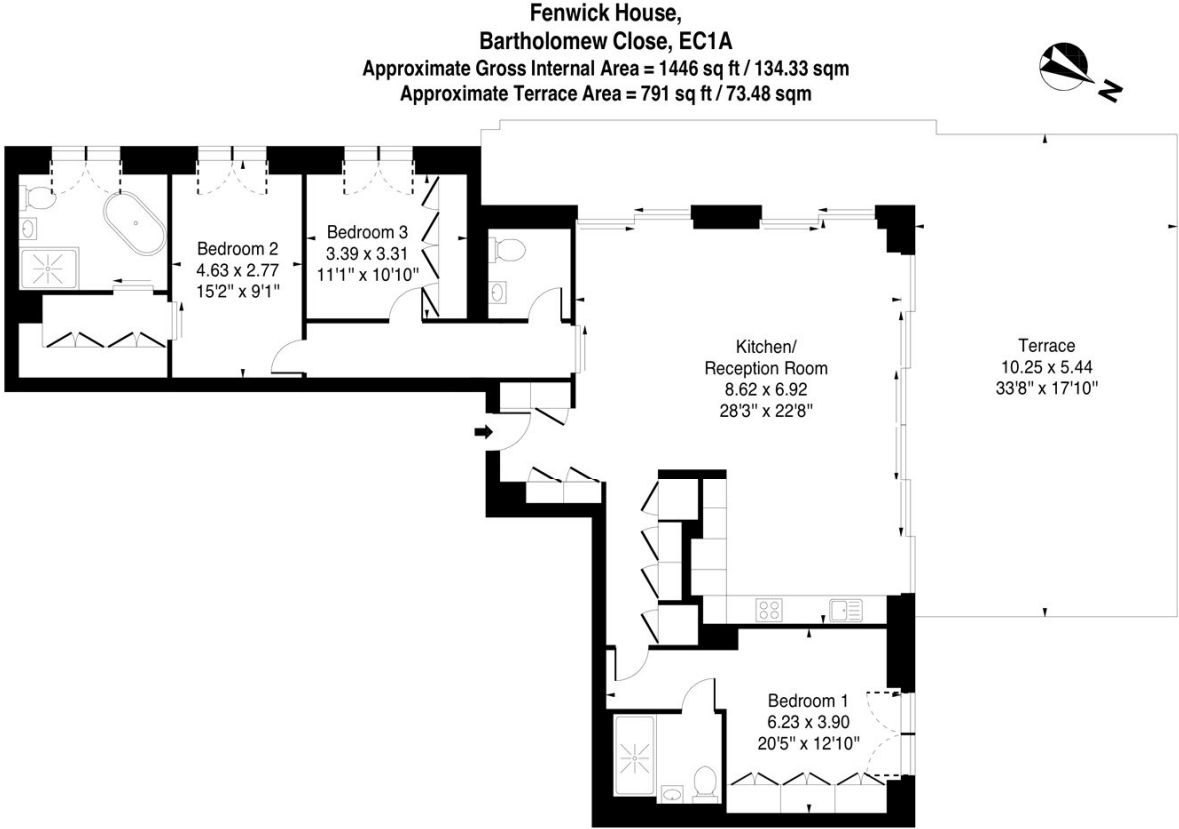

Measured in accordance with RICS guidelines.
This floor plan is for illustrative purposes only
and must not be relied upon as a statement of fact.
© olyphewitt.co.uk

Energy Efficiency Rating		
	Current	Potential
Very energy efficient - lower running costs		
(92+) A		
(81-91) B	82	82
(69-80) C		
(55-68) D		
(39-54) E		
(21-38) F		
(1-20) G		
Not energy efficient - higher running costs		
England, Scotland & Wales		
EU Directive 2002/91/EC		

Important notice Savills, their clients and any joint agents give notice that: 1. They are not authorised to make or give any representations or warranties in relation to the property either here or elsewhere, either on their own behalf or on behalf of their client or otherwise. They assume no responsibility for any statement that may be made in these particulars. These particulars do not form part of any offer or contract and must not be relied upon as statements or representations of fact. 2. Any areas, measurements or distances are approximate. The text, images and plans are for guidance only and are not necessarily comprehensive. It should not be assumed that the property has all necessary planning, building regulation or other consents and Savills have not tested any services, equipment or facilities. Prospective tenants must satisfy themselves by inspection or otherwise. Please note that the local area may be affected by aircraft noise, you should make your own enquiries regarding any noise within the area before you make any offer.

*There are different rules and fees for different tenancy types. For details of our fees and charges please go to Savills.co.uk/tenant-fees. For more detailed information read our applicant guide at savills.co.uk/applicant-guide.
Hard copy available on request. . 20211123CLO

