

LEISURE OPPORTUNITY AVAILABLE

# The Open University

Walton Hall, MK7 6BB



## Savills London

33 Margaret  
Street London  
W1G 0JD

[savills.co.uk](http://savills.co.uk)



savills

## Location

Located within The Open University's Milton Keynes campus, the site forms part of a major regional employment hub accommodating up to 5,500 staff members.

The location benefits from excellent transport connectivity via the nearby M1 motorway and Milton Keynes Central railway station, which provides direct services to London Euston in just 38 minutes. On site parking for customers and visitors is also available.

Landmarks in the vicinity include:

- The Kingston Centre
- Stadium MK
- Centre:MK
- Xscape
- Milton Keynes University Hospital

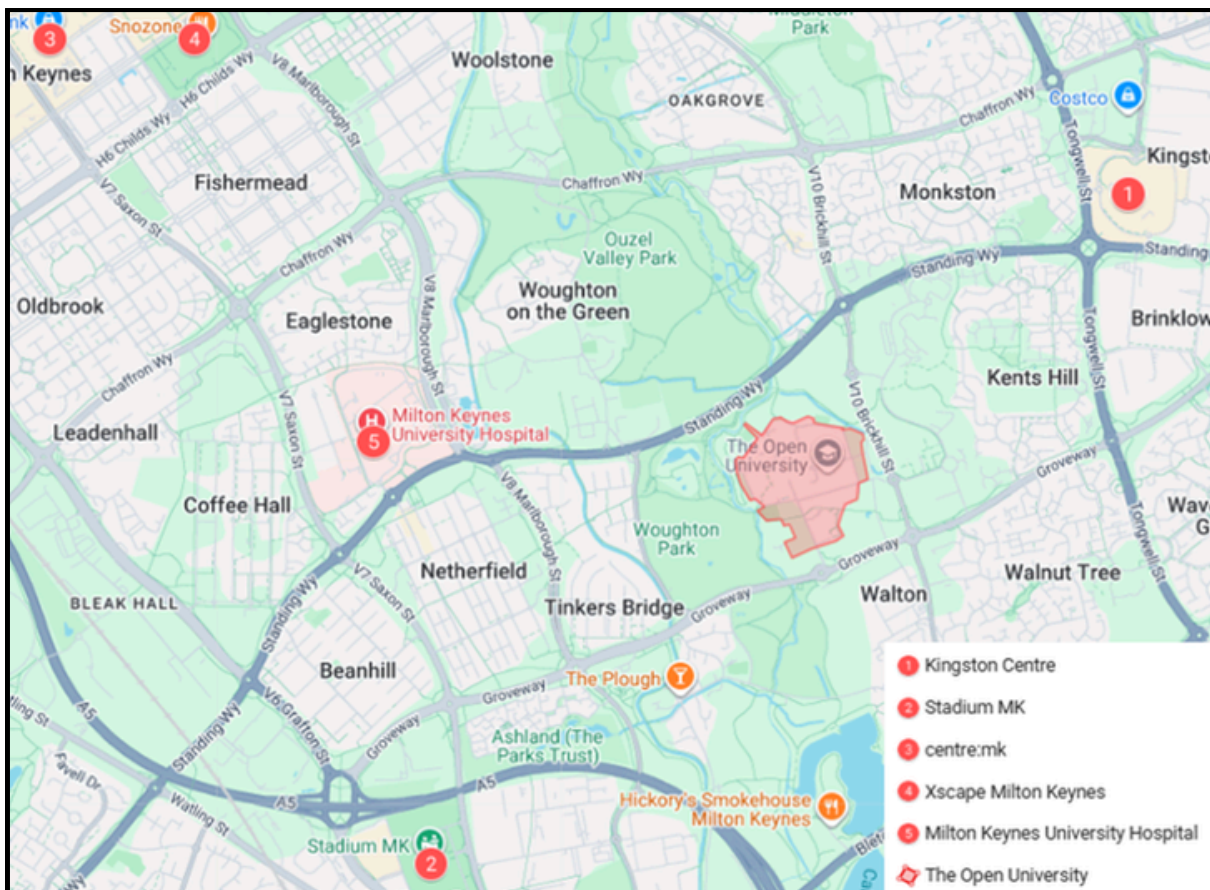

## Viewing & further information

Further Information & Viewing upon request. Viewing strictly via appointed agents only :

**Jess Hill**  
Jessica.Hill@savills.com  
+44 (0) 7976 747 891

**Carlene Hughes**  
CHughes@savills.com  
+44 (0) 7972 000 187

**James Shaw**  
James.Shaw@savills.com  
+44 (0) 7812 447 118



## Accommodation

The premises is arranged over ground floor only, providing the following areas:

Ground : 17,286 sq ft 1,606 sq m

---

**Total: 17,286 sq ft 1,606 sq m**

---

A split of the space will be considered.

## Tenure

The property is available by way of a new full repairing and insuring lease for a term to be agreed, and subject to 5 yearly upwards only rent reviews.

## Rent

Quoting rent available upon application.

## Service Charge

Available upon application.

## Rates

Rates are to be reassessed.

## Use

The premises currently benefits from class E use which includes various commercial uses including Retail, Restaurant, Office, or Gym space without the need for change of use. Other uses will be considered, subject to planning.

## EPC Rating

EPC available upon request.

## Legal Costs

Each party to be responsible for their own legal costs incurred in this transaction.



---

### IMPORTANT NOTICE

Savills, their clients and any joint agents give notice that:

1. They are not authorised to make or give any representations or warranties in relation to the property either here or elsewhere, either on their own behalf or on behalf of their client or otherwise. They assume no responsibility for any statement that may be made in these particulars. These particulars do not form part of any offer or contract and must not be relied upon as statements or representations of fact.  
2. Any areas, measurements or distances are approximate. The text, images and plans are for guidance only and are not necessarily comprehensive. It should not be assumed that the property has all necessary planning, building regulation or other consents and Savills have not tested any services, equipment or facilities. Purchasers must satisfy themselves by inspection or otherwise.

Maps are reproduced from the Ordnance Survey Map with the permission of the Controller of H.M. Stationery Office. © Crown copyright licence number 100022432 Savills (UK) Ltd, and published for the purposes of identification only and although believed to be correct accuracy is not guaranteed. Designed and produced by Savills Marketing: 020 7499 8644 | 2026

The Savills logo, consisting of the word "savills" in a lowercase, sans-serif font, with the 'i's having dots, set against a yellow rectangular background.

Notes:

Contractors must check all dimensions prior to the commencement of the contract. Any discrepancies must be reported to the project co-ordinator before proceeding with the contract.

All dimensions and sizes are in millimetres unless otherwise stated.

No part of this drawing may be reproduced, stored in any retrieval system or transmitted in any form without prior permission of The Open University Estates Department.

| Rev | Date   | Description | By | Chk'd |
|-----|--------|-------------|----|-------|
| A   | Jul 20 | First Issue | TT | -     |

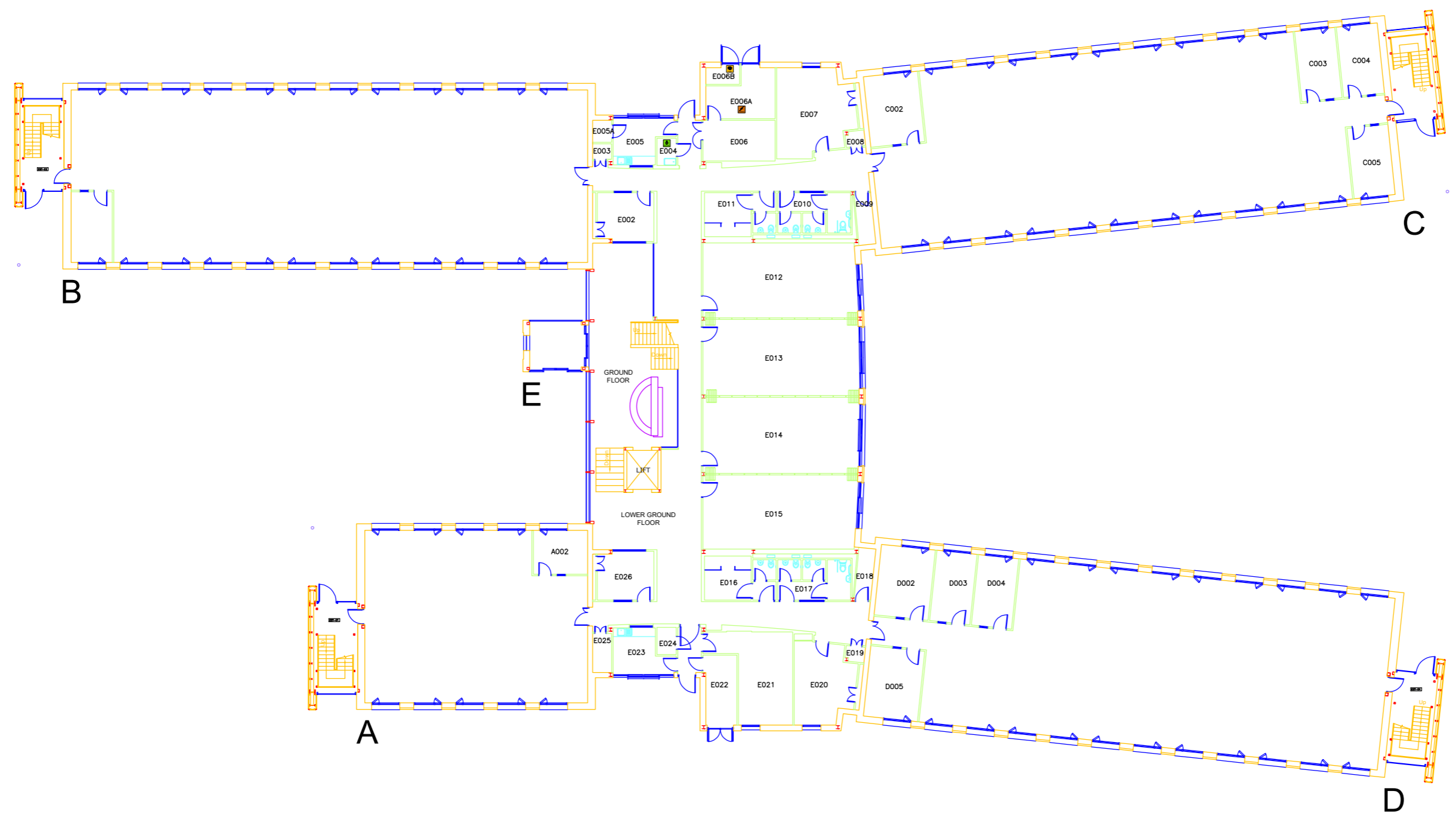

**Estates**  
 Walton Hall  
 Milton Keynes  
 MK7 6AA  
 Tel: 01908 653826

|                             |                  |
|-----------------------------|------------------|
| Drawing Status              |                  |
| AS BUILT                    |                  |
| Project ref / no            | Discipline       |
| -                           | Floor Plan       |
| Building Name               | Building No      |
| Michael Young               | -                |
| Floor                       | Site             |
| Ground Floor                | OU - Walton Hall |
| Drawing description         |                  |
| Updated Floor Plan          |                  |
| Revision                    | Date             |
| B.00                        | January 2015     |
| Drawn / updated By          | Scale            |
| I.D.S.                      | 1:150 @ A1       |
| Drawing number or file name |                  |
| MYOUNG-GF_FLOORPLAN         |                  |

Notes:

Contractors must check all dimensions prior to the commencement of the contract. Any discrepancies must be reported to the project co-ordinator before proceeding with the contract.

All dimensions and sizes are in millimetres unless otherwise stated.

No part of this drawing may be reproduced, stored in any retrieval system or transmitted in any form without prior permission of The Open University Estates Department.

| Rev | Date   | Description | By | Chk'd |
|-----|--------|-------------|----|-------|
| A   | Feb 20 | First Issue | TT | -     |



**Estates**  
 Walton Hall  
 Milton Keynes  
 MK7 6AA  
 Tel: 01908 653826

| Drawing Status                                       |          | RECORD STATUS |                  |
|--|----------|---------------|------------------|
| Project ref / no                                     | N/A      | Discipline    | Site Plan        |
| Building Name  | CAMPUS   | Building No   |                  |
| Floor  | SITE     | Site          | OU - Walton Hall |
| Drawing description<br>Walton Hall - Site Plan       |          |               |                  |
| Revision   | B        | Date          | May 2015         |
| Drawn / updated By                                   | E. Noble | Scale         | 1:1250@A1        |
| Drawing number or file name<br>WALTONCAMPUS-SITEPLAN |          |               |                  |



We connect the dots  
between landlords,  
brands and powerful  
consumer insights

[Find out more here](#)

**Savills London**

33 Margaret  
Street London  
W1G 0JD

[savills.co.uk](http://savills.co.uk)



savills