

Area
 Total Laboratory Area = 501.13sqm / 5,394.11sqft
 Total Office Area = 507.2sqm / 5459.45sqft
 Total Area - 1008.33sqm / 10,853.56sqft

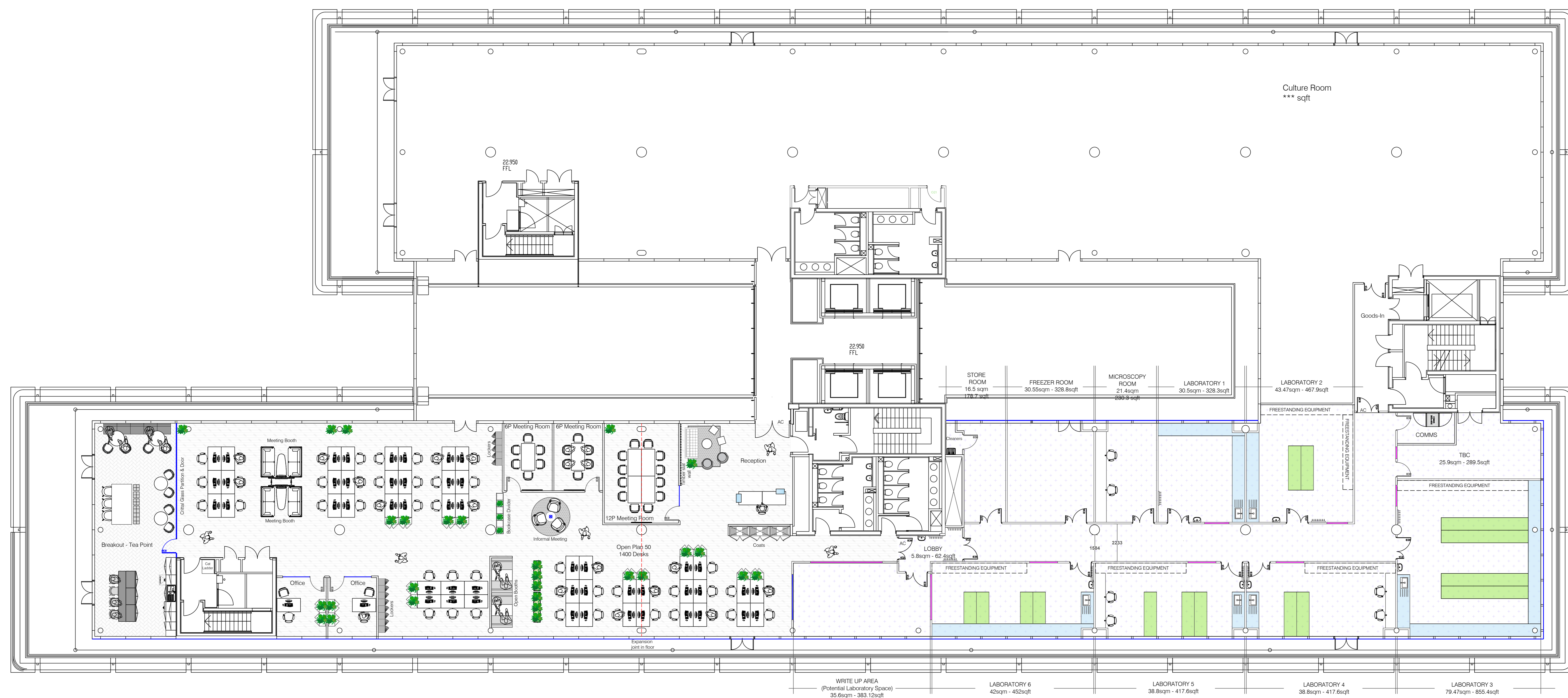

- Equipment Legend**
- Equipment - Free-standing
 - Equipment - On Bench
 - Lab Bench
 - Lab Bench
 - Mobile Lab Bench
 - Lab Shelving
 - Storage Unit
 - Storage Cabinet
 - Freezer - Free-standing
 - Fridge - Free-standing
 - Undercounter Fridge / Freezer
 - Lab Sink
 - P3 Hand Wash Basin
 - Rotating Worktop Point
 - CO2 Depletion Alarm
 - DW Under bench dishwasher
 - AMMS Cool Hooks
 - Ice Machine

Rev	Revision	By	Date	CHK	Date
B	REVISIONS TO BUILDING DETAILS	JS	13/12/22	DN	13/12/22
A	FIRST ISSUE	JS	10/11/22	MC	01/11/22

bulb
 LABORATORIES

BULB INTERIORS, PRIORY COURT, WOOD LANE
 BEECH HILL, BERKSHIRE RG7 2BJ
 T: 01185 889200 F: 01185 889350
 www.bulbinteriors.com

Client
 ARC

Project
 FOURTH FLOOR
 WATERFRONT BUILDING
 MANBRE WHARF

Title
 FOURTH FLOOR

Scale
 1:100@A0

Date
 30-11-22

Designer/Drawn By
 JS

Checked By
 MK

Project No.	Drawing No.	Floor	Detail	Rev
P22109	01	04	GA01	B