

NOTE  
 SURROUNDING CONTEXTUAL BUILDINGS AND INFORMATION ARE BASED ON RECEIVED ORDINANCE SURVEY DRAWINGS AND ARE SHOWN FOR ILLUSTRATIVE PURPOSES ONLY. ASSUMED SITE BOUNDARY IS SUBJECT TO CONFIRMATION

General Notes:  
 All proposed tree locations are subject to co-ordination with drainage layout and subject to modification depending on the location of underground services and utilities. Drainage Engineer to co-ordinate services layout in conjunction with the landscape plan to avoid conflict as much as possible.  
 Allowance to be made at tender stage for the possible requirement for root barriers once the drainage layout is confirmed. CA to be informed immediately once this is available.

Scale: 1:500 @ A0  
 0 5 10 20 50m 100m

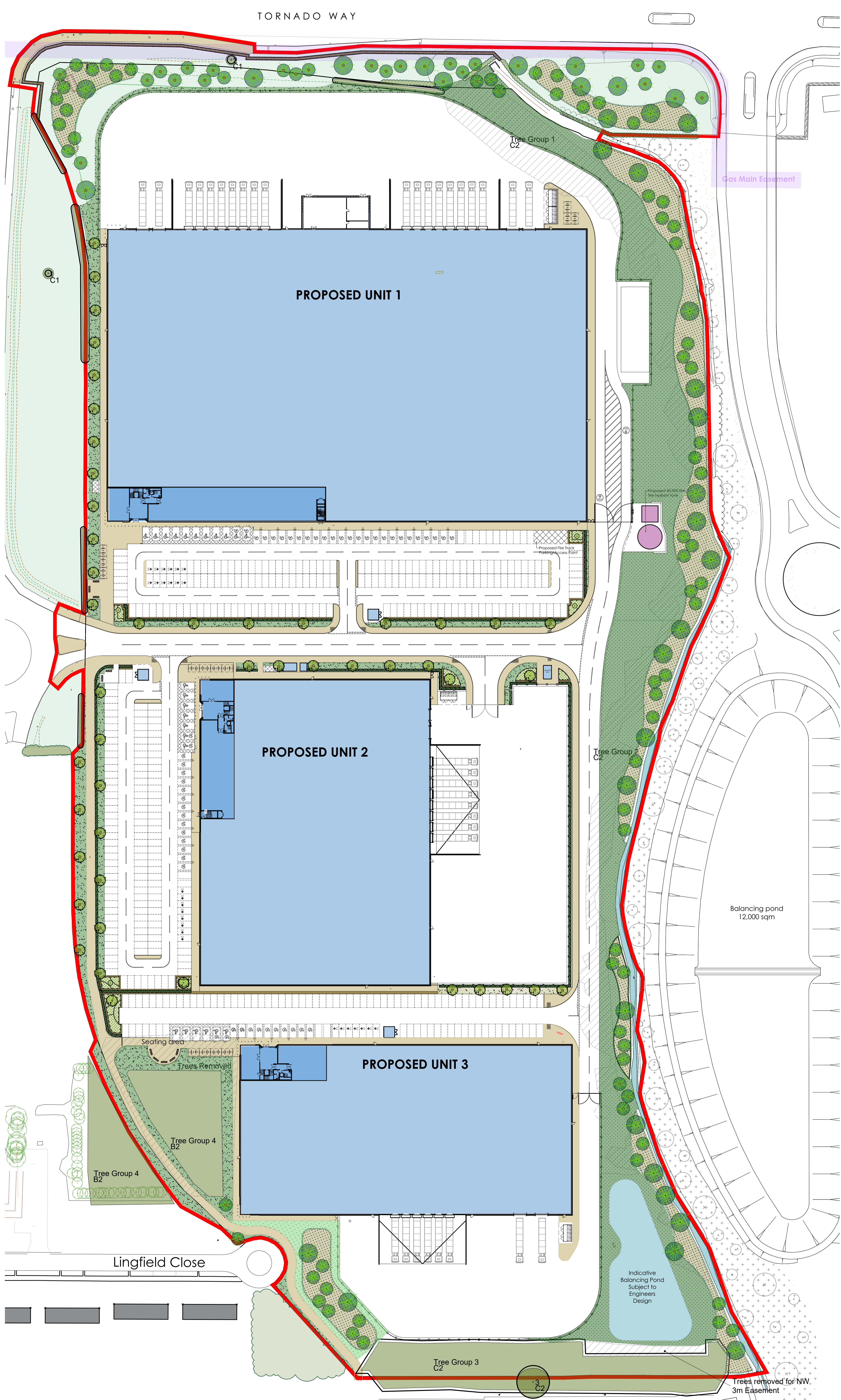

- SOFT LANDSCAPE KEY:**
- Existing trees to be removed  
In order to facilitate the proposed development
  - Existing trees to be retained  
Retained and protected during construction and landscape works in accordance with BS5837:2012 guidance
  - Proposed trees in soft landscape  
Refer to Vector Landscape plan 17475-VL\_L102, L103, L104 for planting schedule for species & specification
  - Proposed native trees in soft landscape  
Refer to Vector Landscape plan 17475-VL\_L102, L103, L104 for planting schedule for species & specification
  - Proposed specimen shrub planting  
Refer to Vector Landscape plan 17475-VL\_L102, L103, L104 for planting schedule for species & specification
  - Proposed ornamental shrub planting  
Refer to Vector Landscape plan 17475-L102, L103, L104 for planting schedule for species & specification
  - Proposed mixed species boundary Mix  
Refer to Vector Landscape plan 17475-VL\_L102, L103, L104 for planting schedule for species & specification
  - Proposed formal hedge planting  
Refer to Vector Landscape plan 17475-VL\_L102, L103, L104 for planting schedule for species & specification
  - Proposed mixed species native hedge planting  
Refer to Vector Landscape plan 17475-VL\_L102, L103, L104 for planting schedule for species & specification
  - Proposed close mown grass area  
To be cultivated amenity turf
  - Existing grassland to be retained
  - Proposed species rich flowering lawn grassland (EL1)  
Area to be seeded with species rich mix over cultivated subsoil
  - Proposed species rich wetland grassland (EM8)  
Area to be seeded with species rich mix over cultivated subsoil
  - Proposed ornamental bark mulch surface finish  
• 1m dia of ornamental bark mulch in accordance with BS58545  
• :2014 recommendations  
• 500mm maintenance margin / over run strip

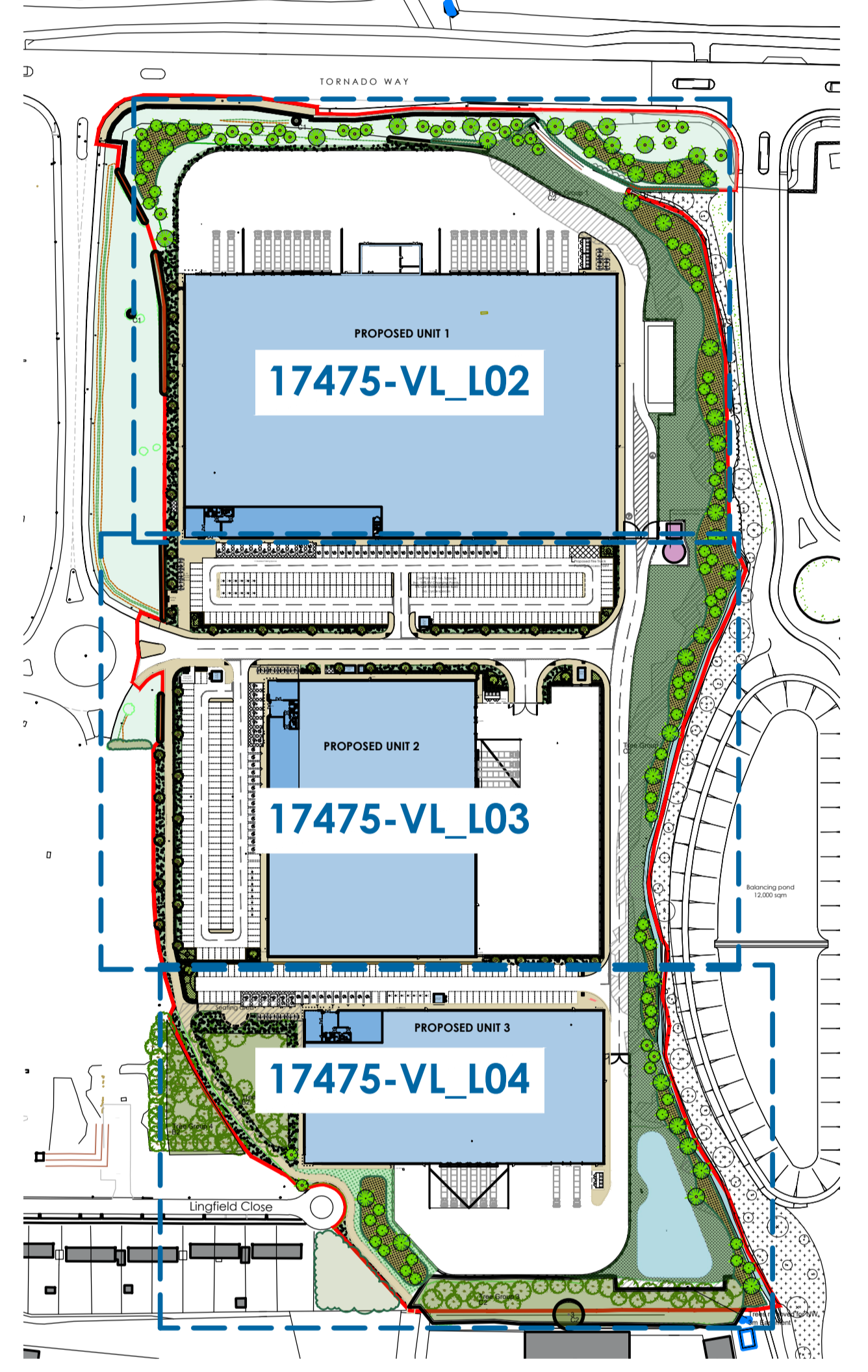

<p>For Planting Schedule refer to Vector Landscape Plan Drawing 17475-VL_L02, L03, L04</p> <p>For Soft Landscape Specification notes refer to Vector Landscape Plan Drawing 17475-VL_L04</p>	<p>1:21.01.2024 updated to co-ordinate with Architects site plan</p> <p>01:15.04.2023 updated to co-ordinate with Architects site plan and package comments</p> <p>01:04.04.2023 updated to co-ordinate with Architects site plan</p> <p>01:04.04.2023 updated to co-ordinate with Architects site plan</p> <p>01:04.04.2023 updated to co-ordinate with Architects site plan</p>	<p>HW AS</p> <p>FW AS</p> <p>FW AS</p> <p>FW AS</p> <p>FW AS</p>
<p>Project Site: PROPOSED INDUSTRIAL DEVELOPMENT</p> <p>Client: WYNGROVE LTD</p> <p>Status: PLANNING</p> <p>Scale: 1:500 Drawing Size: A0</p> <p>Drawn By: FW Checked By: AS Date: 04/2022</p>	<p>Drawing Title: LANDSCAPE MASTERPLAN</p> <p>Alt/Draw No: 17475-VL-L01 Rev: E</p>	<p><b>vector</b> design concepts</p> <p>LANDSCAPE DESIGNERS</p> <p>4 ST JOHN'S NORTH, WAKEFIELD, WF1 3QA, TEL: 01924 322556 www.vector.co.uk</p>