

PROPOSED UNIT 1
 213,000sqft 19,768 sqm
 Total Gross Internal Area

| | | |
|---------------------|--------------|------------|
| Footprint | 203,000 sqft | 18,869 sqm |
| First Floor offices | 10,000 sqft | 929 sqm |

15m clear to underside of Haunch
 Finish floor level - 53.00 AOD (+/- 200mm)
 All areas are measured as gross internal

Proposed Ground Floor
 1 : 200

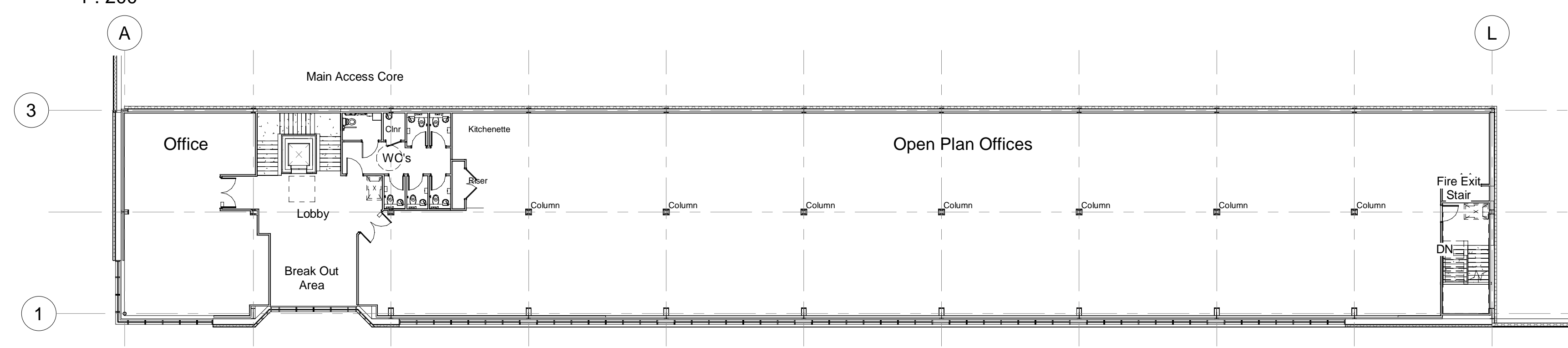

Proposed First Floor Offices
 1 : 200

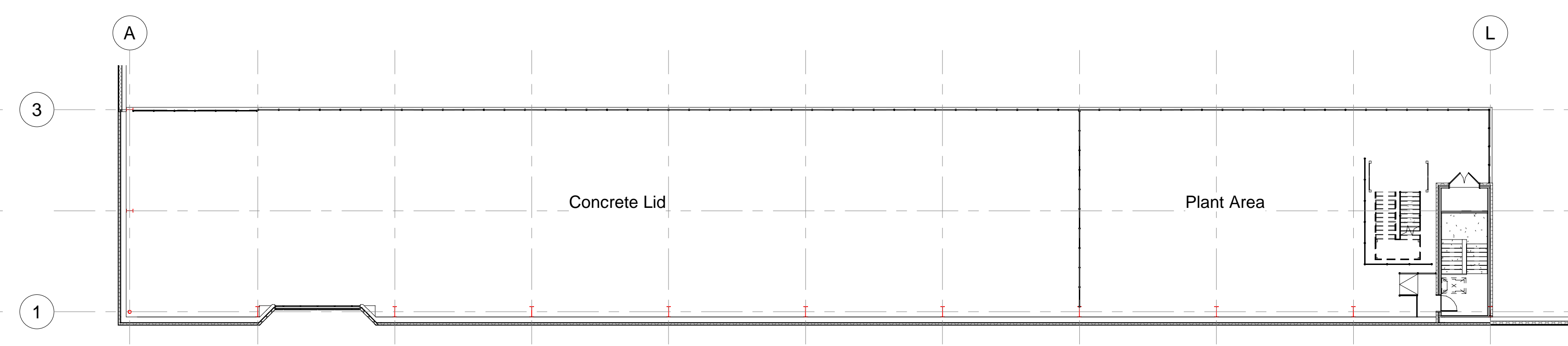

Proposed Plant Deck
 1 : 200

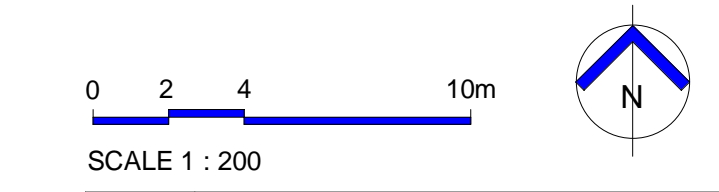

| | | | |
|-------------|---------------------------------|--------------|-----|
| Project No. | Proposed Industrial Development | | |
| Client | Wyngrove Limited | | |
| Phase | PLANNING | | |
| Scale | As Indicated | Drawing Size | A0 |
| Drawn By | NBB | Checked By | JMR |
| Date | 04.22 | | |

UNIT 01 - Proposed GA Plans

17475 - (P)123

Walsford, WF1 3GA
 01924 291000
 Cannon Warehouse, 77 Dale Street,
 Manchester, M1 7FG
 0161 2388555
 The Old Brewery, 99 High Street,
 Newport, NP23 5UJ
 01693 211717
 801 London Road,
 Reading, RG1 1JF
 0118 9577000
 10 Green Court, 10 Christchurch Place,
 London, W1D 1JF
 0203 8091212

THE HARRIS PARTNERSHIP
 A R C H I T E C T S
 www.harrispartnership.com