

**The Moorings, Bridge Street, Loughborough**  
**Ground Floor gross internal area = 3,914 sq ft / 364 sq m**  
**First Floor gross internal area = 1,076 sq ft / 100 sq m**  
**Total gross internal area = 4,990 sq ft / 464 sq m**

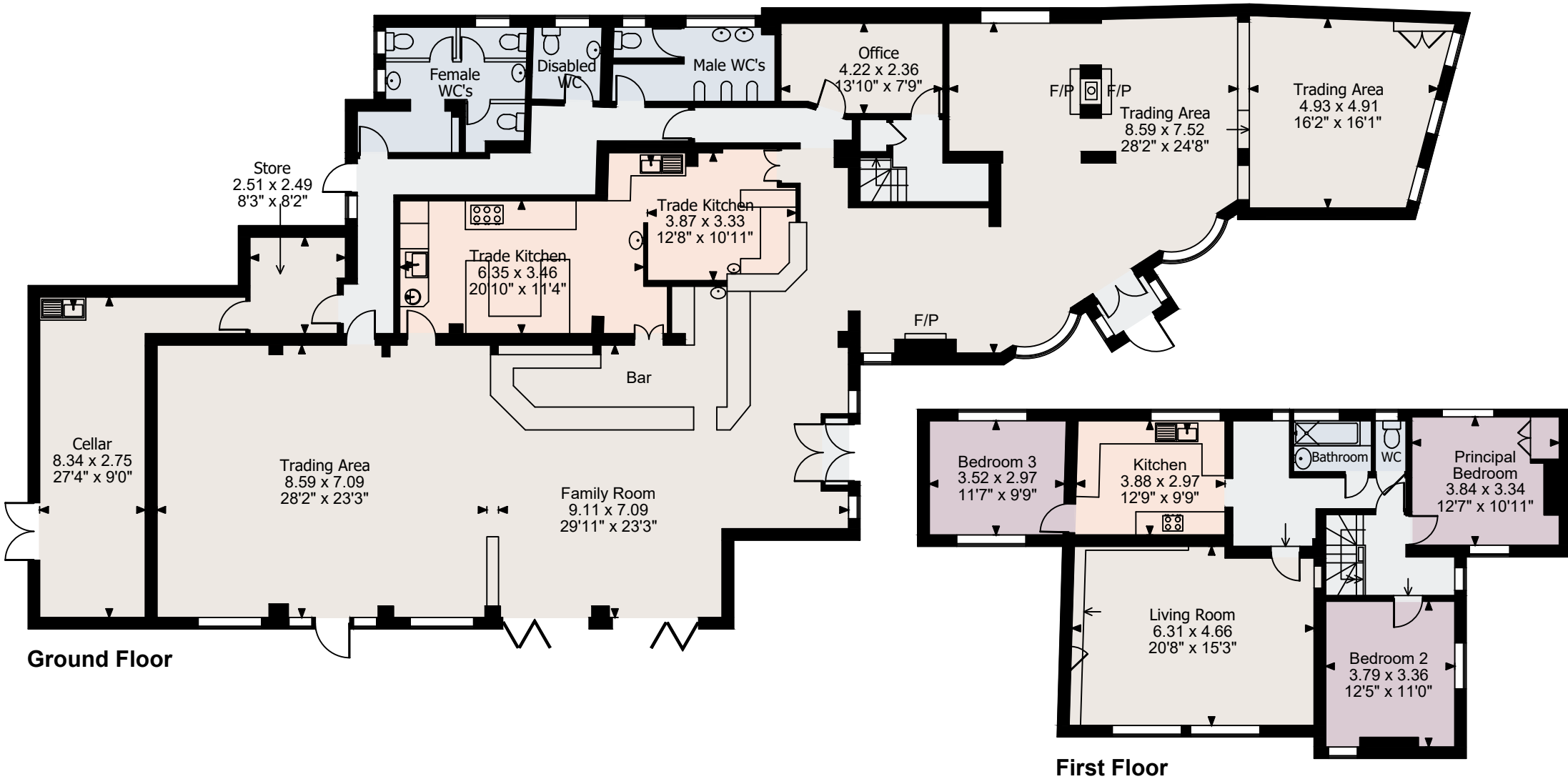

**FOR ILLUSTRATIVE PURPOSES ONLY - NOT TO SCALE**

The position & size of doors, windows, appliances and other features are approximate only.

© ehouse. Unauthorised reproduction prohibited. Drawing ref. dig/8658024/NJA