

FIRST FLOOR PLAN.

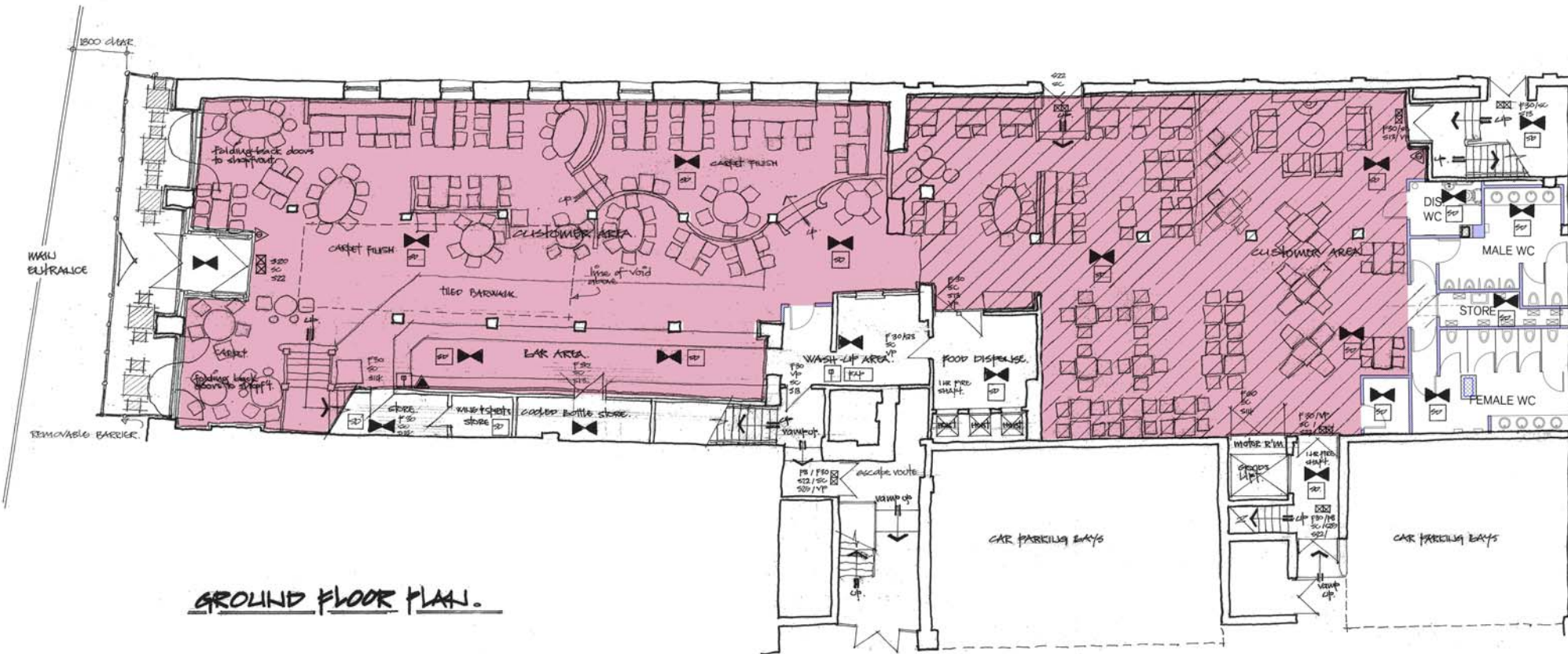

GROUND FLOOR PLAN.

LICENCE KEY.

FIRE AUTHORITY REQUIREMENTS

- F30 Half hour fire resistant door with cold smoke seals and intumescent strips
- F60 One hour fire resistant door with cold smoke seals and intumescent strips
- VP Vision panel in door(s)
- PB Panic bolt to door(s)
- SC Self closing door(s)
- SCA Self closing door(s) with automatic release
- FL Fusible link
- DS Door selector
- IS3 Illuminated suspended sign with "FIRE EXIT" in letters 75mm high
- SI3 Sign applied to both sides of door(s) with "FIRE DOOR KEEP SHUT" in letters 10mm high
- SI4 Sign applied to both sides of door(s) with "FIRE DOOR KEEP LOCKED" in letters 10mm high
- S20 Sign applied to both sides of door(s) with "FIRE ESCAPE KEEP CLEAR" in letters 10mm high
- S22 Sign applied to door(s) with "FIRE EXIT" in letters 20mm high
- S25 Sign applied to door(s) with "PUSH BAR TO OPEN" in letters 20mm high
- S26 Sign with directional arrow for means of escape
- FRG Fire resistant glazing
- Indicates an area covered by emergency lighting to BS 5266 Part 1.
- Indicates an area covered by smoke detectors
- Indicates an area covered by heat detectors
- Fire alarm call point
- F.A.P. Fire alarm indicator panel
- Fire blanket in container
- Carbon dioxide fire extinguisher
- 9 litre water fire extinguisher
- Dry powder fire extinguisher
- Foam fire extinguisher
- Alarm warning device

All walls and partitions to be a minimum of half hour fire resistant
 Emergency lighting to comply with BS 5266 Part 1
 Fire safety related signs and notices to comply with BS 5499
 Fire fighting equipment to comply with BS 5306
 Wall and ceiling linings are to be Class 1 for surface spread to flame to all areas except escape routes which are to be Class 0
 Upholstered seating is to satisfy the following -
 - ignition source (cigarette test) as specified in BS 5852 Part 1
 - fire test for furniture and methods of test for ignitability by smokers
 - BS 5852 Part 2 fire test for furniture - methods of test for the ignitability of upholstered composites for testing by flaming source, a minimum test to be Crib Ignition source 5
 Fabrics that have had a flame retardant treatment to pass the water soak test as detailed in BS 5651 are to have a test certificate submitted to the fire authority
 Curtains and drapes are to satisfy Type B performance requirements to BS 5867 Part 2
 Artificial foliage and decorative effects to be fire retardant to the satisfaction of the fire authority

TOILETS All walls to be tiled full height
 Sanitary facilities have been designed to BS 6465 Part 1 1994
 Code of Practice for the scale and provision, selection and installation of sanitary appliances

KITCHEN All walls to be tiled full height
 Ambit line indicating customer area including bar