

DO NOT SCALE FROM THIS PRINT OR USE AS A TEMPLATE
 All dimensions must be verified on site before any work is put in hand and any discrepancies must be reported to Murdoch Bowers LTD.
 Written dimensions indicate finished sizes.
 Detailed drawings to be worked to when supplied.
 Copyright of this drawing is reserved by Murdoch Bowers LTD and is issued on the condition that it is not copied or disclosed to any third party either wholly or in part without the consent in writing of Murdoch Bowers LTD.

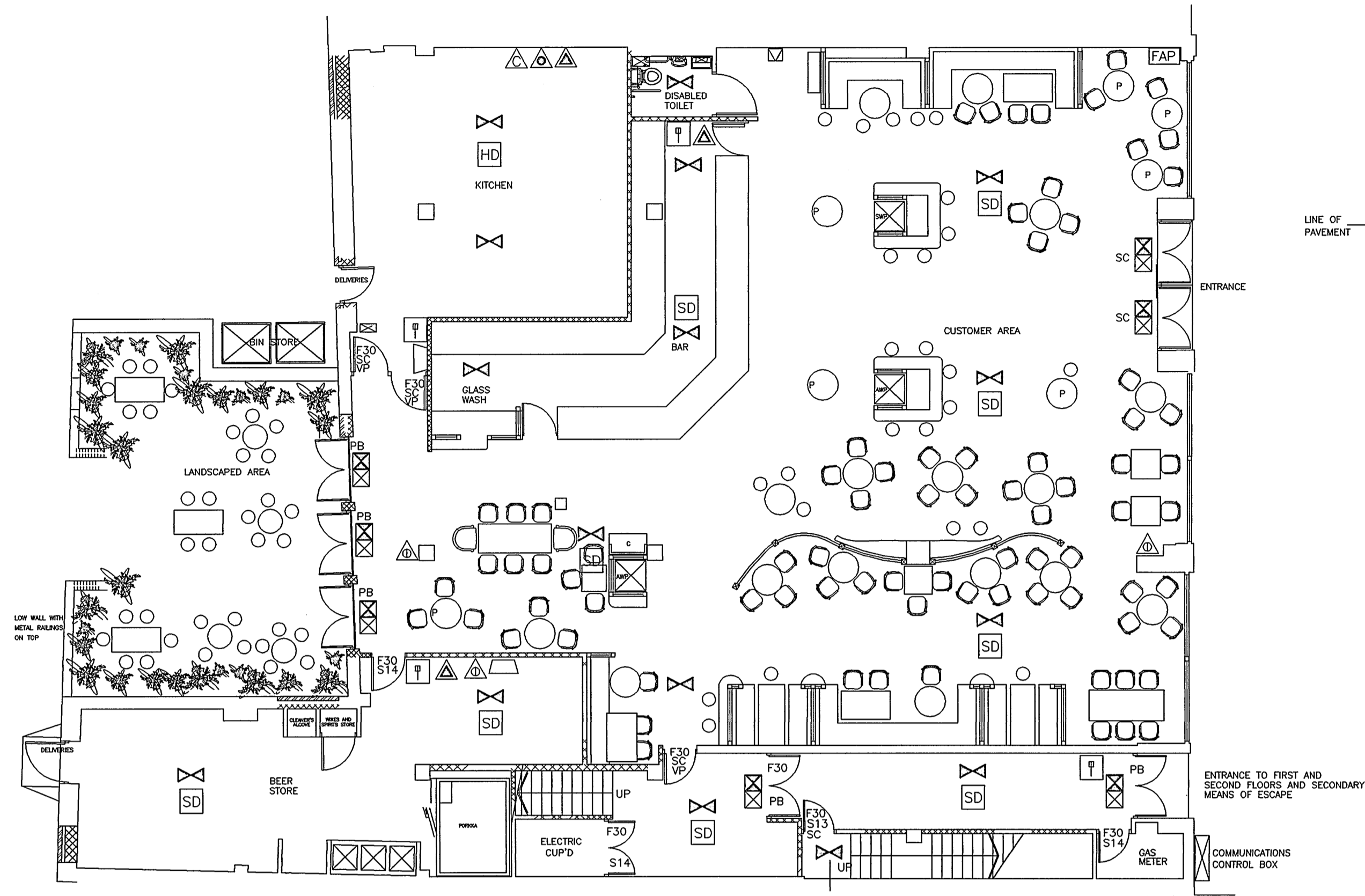

GROUND FLOOR PLAN

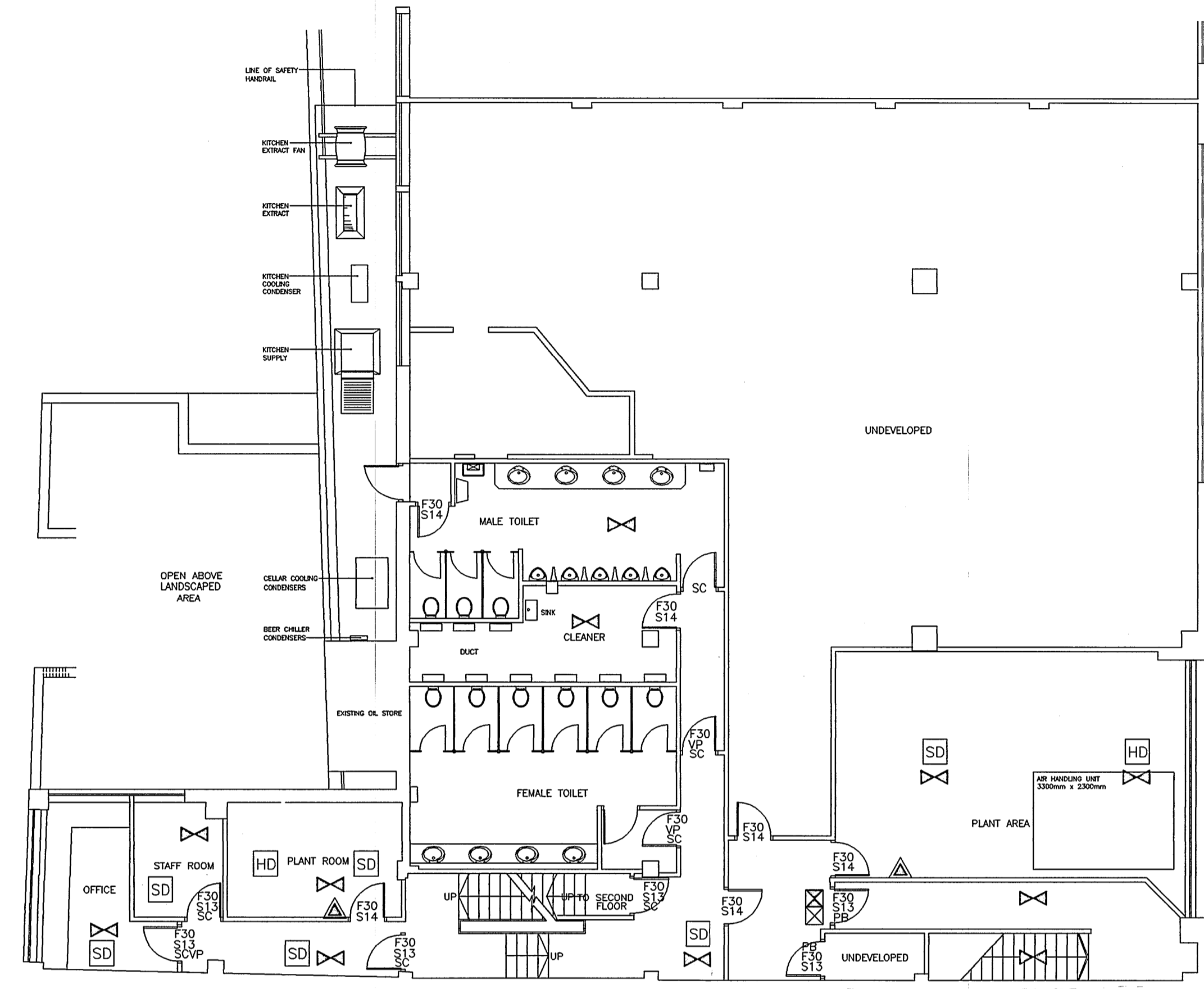

FIRST FLOOR PLAN

KEY TO SYMBOLS FOR FIRE REQUIREMENTS

- F20 TWENTY MINS FIRE RESISTANT WITH SMOKE SEALS AND INTUMESCENT STRIP
- F30 HALF HOUR FIRE RESISTANT WITH SMOKE SEALS AND INTUMESCENT STRIP
- F60 ONE HOUR FIRE RESISTANT WITH SMOKE SEALS AND INTUMESCENT STRIP
- VP VISION PANEL
- PP PANIC PAD
- PB PANIC BAR FASTENING TO BS EN 1125 PARTS 1 & 2 1997.
- SC SELF CLOSING
- SCA SELF CLOSING AUTOMATIC RELEASE
- FL FUSIBLE LINK
- DS DOOR SELECTOR
- DV DOOR VIEWER
- ☒ MAINTAINED EMERGENCY ILLUMINATED SUSPENDED 'FIRE EXIT'

- S13 'FIRE DOOR KEEP SHUT' 10mm LETTERS TO BOTH SIDES OF DOOR LEAF
- S14 'FIRE DOOR KEEP LOCKED' 10mm LETTERS TO BOTH SIDES OF DOOR LEAF
- S20 'FIRE ESCAPE KEEP CLEAR' 10mm LETTERS TO BOTH SIDES OF DOOR LEAF
- S22 'FIRE EXIT' 20mm LETTERS
- S25 'PUSH BAR TO OPEN' 20mm LETTERS
- S26 DIRECTIONAL ARROW (GREEN)
- FRG FIRE RESISTING GLAZING ELEMENT
- ☒ AREA COVERED BY ESCAPE LIGHTING TO BS.5266, PART 1, MAINTAINED
- ☒ AREA COVERED BY ESCAPE LIGHTING TO BS.5266, PART 1, NON MAINTAINED
- SD AREA COVERED BY SMOKE DETECTOR

- HD AREA COVERED BY HEAT DETECTOR
- T FIRE ALARM CALL POINT
- FAP FIRE ALARM CONTROL PANEL
- ☒ FIRE BLANKET IN CONTAINER
- ☒ CARBON DIOXIDE FIRE EXTINGUISHER
- ☒ 9 LITRE WATER FIRE EXTINGUISHER
- ☒ DRY POWDER FIRE EXTINGUISHER
- ☒ FOAM FIRE EXTINGUISHER

NOTE
 ALL PORTABLE FIRE FIGHTING EQUIPMENT TO CONFORM TO BS EN3 : PARTS 1 TO 6 AND BS 7863 : 1996

☒ ALARM WARNING DEVICE

ALL WALLS AND PARTITIONS TO BE MINIMUM HALF HOUR FIRE RESISTANCE.
 EMERGENCY LIGHTING TO COMPLY WITH 1988 EDITION OF BS 5266 PART 1.
 FIRE SAFETY RELATED SIGNS AND NOTICES TO COMPLY WITH THE HEALTH AND SAFETY (SAFETY SIGN AND SIGNAL) REGULATIONS 1996
 FIRE ALARM AND DETECTION SYSTEM TO BE TYPE L1 INSTALLED TO BS 5859.
 FIRE FIGHTING EQUIPMENT TO COMPLY WITH BS 5308 WALL AND CEILING LININGS ARE TO BE CLASS 1 SURFACE SPREAD OF FLAME (AS DEFINED BY BS 476 PART 7) IN PUBLIC AREAS AND CLASS 0 IN ESCAPE ROUTES.
 UPHOLSTERED SEAT FURNITURE TO SATISFY THE FOLLOWING
 * IGNITION SOURCE (CIGARETTE TEST) AS SPECIFIED IN BS 5852 PART 1 FIRE TEST FOR FURNITURE METHODS OF TEST FOR THE IGNABILITY BY SMOKERS.

* BS 5852 PART 2 FIRE TEST FOR FURNITURE - METHODS OF TEST FOR THE IGNABILITY OF UPHOLSTERED COMPOSITES FOR TESTING BY FLAMING SOURCE, MINIMUM TEST TO BE CRB IGNITION SOURCE 5.
 FABRICS THAT HAVE HAD A FLAME RETARDANT TREATMENT TO PASS THE WATER SOAK TEST AS DEFINED BY BS 5651 TEST CERTIFICATE TO BE SUBMITTED TO FIRE AUTHORITY.
 CURTAINS AND DRAPES TO SATISFY TYPE B PERFORMANCE REQUIREMENTS TO BS 5667 PART 2.
 ARTIFICIAL FOLIAGE AND DECORATIVE EFFECTS TO BE FIRE RETARDANT TO THE SATISFACTION OF THE FIRE AUTHORITY.

REVISIONS -

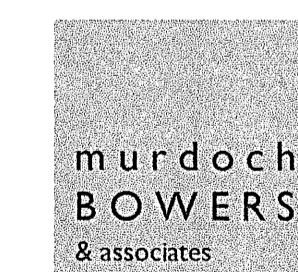

architects
 interior designers
 project managers
 Gemini House, 180-182 Bermondsey St
 London SE1 3TQ
 Tel 020 7378 0885 Fax 020 7378 7948

CLIENT
 J D WETHERSPOON PLC

PROJECT
 PUB NO: 0876, THE LORD ARTHUR LEE
 WEST STREET, FAREHAM. PO16 0EP

DRAWING
 GROUND AND FIRST FLOOR
 LICENSING PLANS

SCALE	DATE	DRAWN
1:100	MAY 05	
PROJECT No	DRAWING No	REVISION
1669	LIC-2005	