

Kings Head, Church Street, Horsham, West Sussex

Basement gross internal area = 987 sq ft / 92 sq m

Ground Floor gross internal area = 1,200 sq ft / 112 sq m

First Floor gross internal area = 622 sq ft / 58 sq m

Store gross internal area = 15 sq ft / 1 sq m

Total gross internal area = 2,824 sq ft / 262 sq m

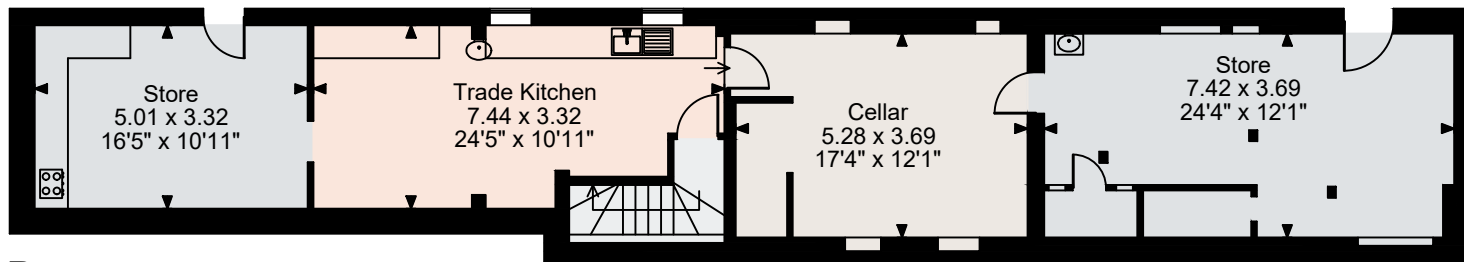
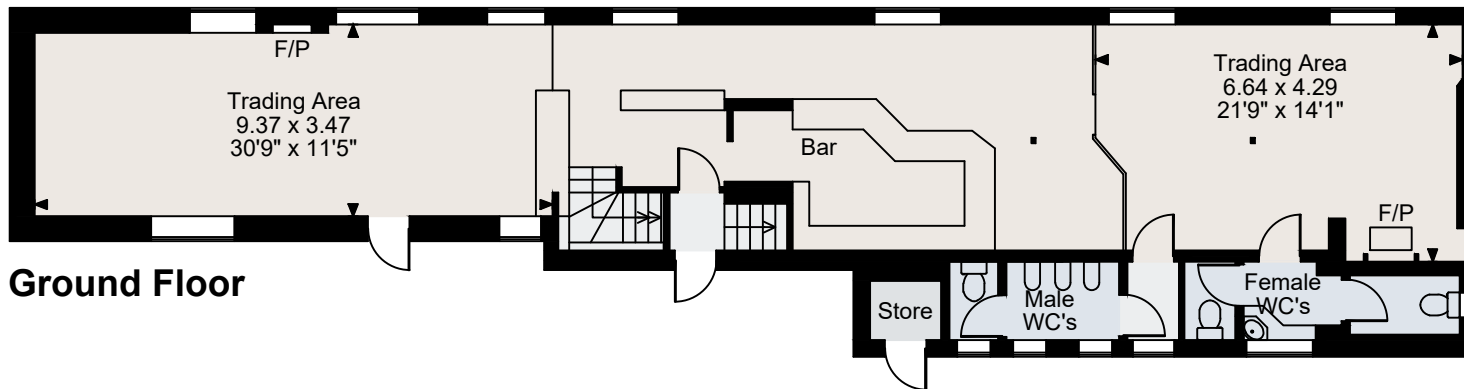
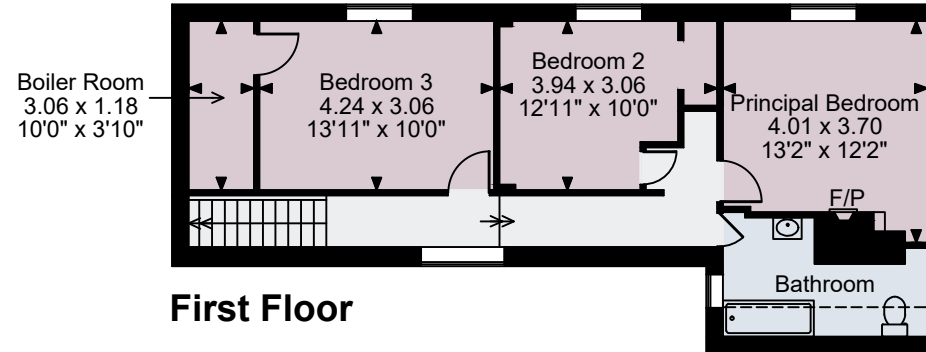

FOR ILLUSTRATIVE PURPOSES ONLY - NOT TO SCALE

The position & size of doors, windows, appliances and other features are approximate only.

© ehouse. Unauthorised reproduction prohibited. Drawing ref. dig/8627314/SLU