

Notes

This drawing is not to be scaled from  
All dimensions to be checked on site  
Refer any discrepancies to Architect  
This drawing is subject to copyright

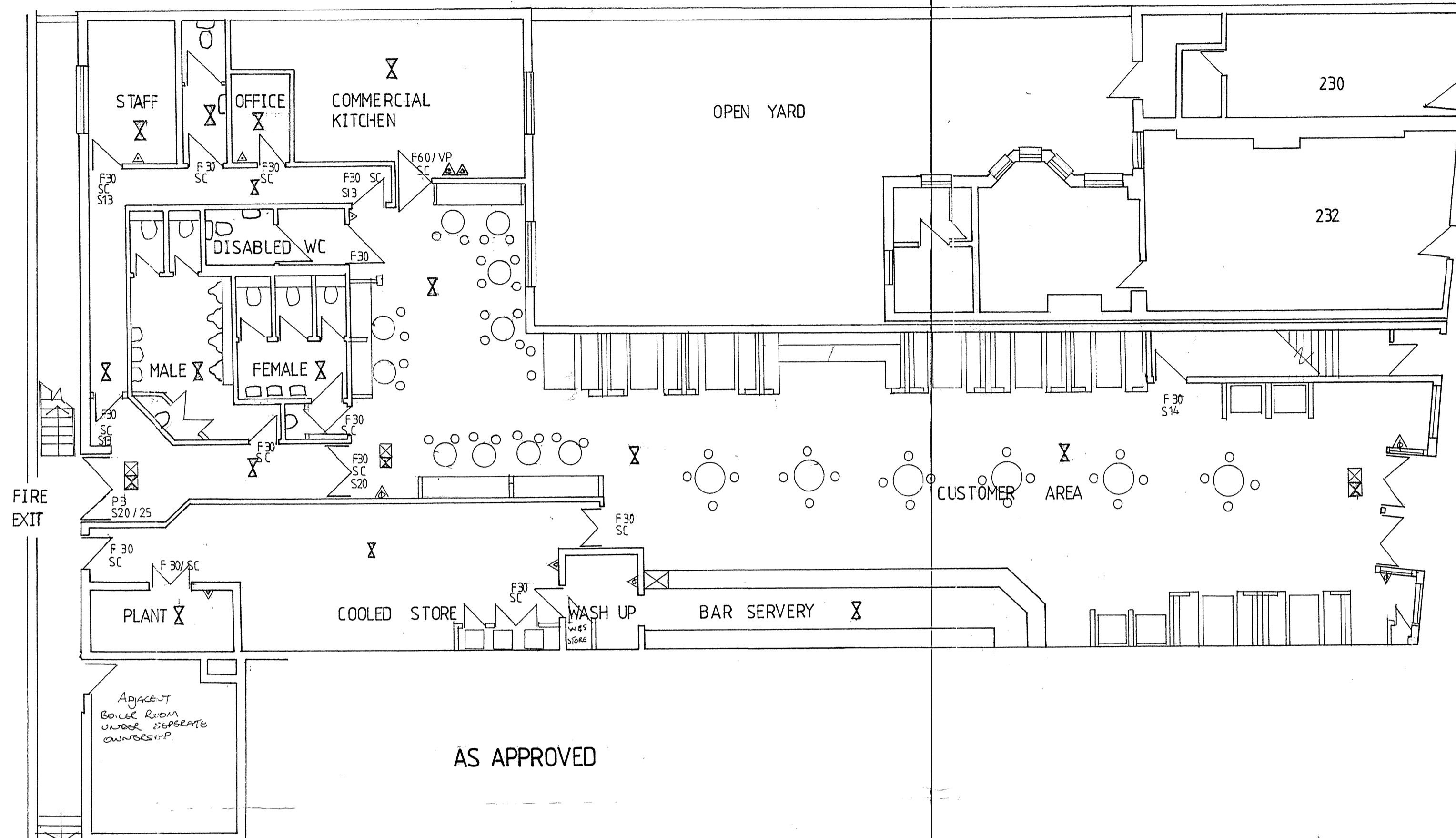

AS APPROVED

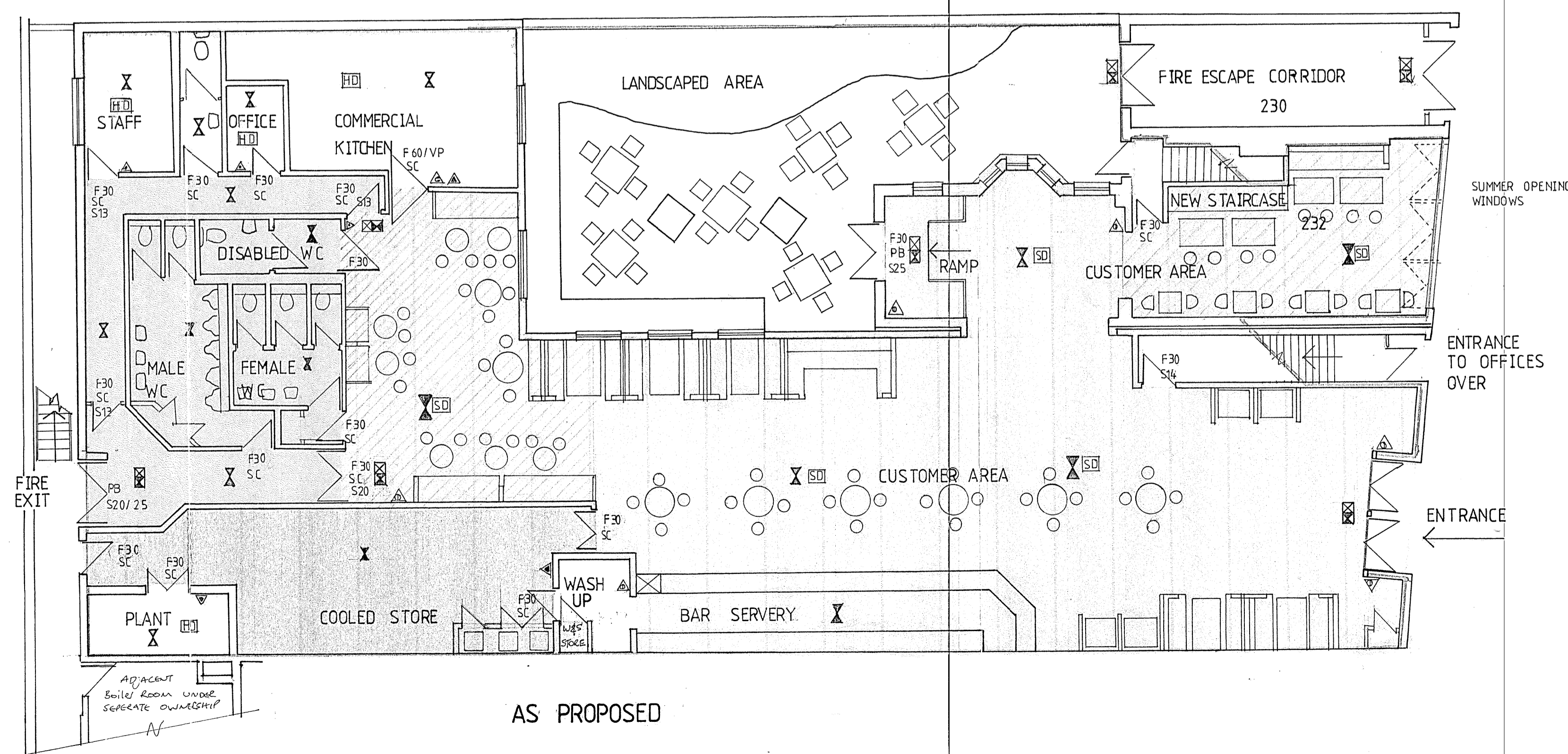

AS PROPOSED

FIRE AUTHORITY REQUIREMENTS

F30	HALF HOUR FIRE RESISTANT WITH SMOKE SEALS & INTUMESCENT STRIPS	ALL WALLS AND PARTITIONS TO BE MINIMUM HALF HOUR FIRE RESISTANT
F60	ONE HOUR FIRE RESISTANT WITH SMOKE SEALS & INTUMESCENT STRIPS	EMERGENCY LIGHTING TO COMPLY WITH BS 5266 PART 1
VP	VISION PANEL	FIRE SAFETY RELATED SIGNS AND NOTICES TO COMPLY TO BS 5499
PB	PANIC BOLT	FIRE FIGHTING EQUIPMENT TO COMPLY WITH HALL AND CEILING LININGS ARE TO BE CLASS 1 SURFACE SPREAD OF FLAME (AS DEFINED BY BS 476 PART 7) IN PUBLIC AREAS AND CLASS 0 IN ESCAPE ROUTES
SC	SELF-CLOSING	UPHOLSTERED SEATING FURNITURE TO SATISFY THE FOLLOWING
SCA	SELF-CLOSING AUTOMATIC RELEASE	* KNITTON SOURCE (CIGARETTE TEST) AS SPECIFIED IN BS 5852 PART 1
FL	FUSIBLE LINK	FIRE TEST FOR FURNITURE METHODS OF TEST FOR THE KNITABILITY BY SMOKERS
DS	DOOR SELECTOR	* BS 5852 PART 2 FIRE TEST FOR FURNITURE - METHODS OF TEST FOR THE KNITABILITY OF UPHOLSTERED COMPOSITES FOR TESTING BY FLAMING SOURCE, MINIMUM LIGHTING TO BE CRIB KNITTON SOURCE 5
☒	ILLUMINATED SUSPENDED "FIRE EXIT" SIGN 75mm LETTERS	FABRICS THAT HAVE HAD A FLAME RETARDANT TREATMENT TO PASS THE WATER SOAK TEST AS DETAILED BY BS 5851, TEST CERTIFICATE TO BE SUBMITTED TO FIRE AUTHORITY
S13	"FIRE DOOR KEEP SHUT" 10mm LETTERS TO BOTH SIDES OF DOOR LEAF	CURTAINS AND DRAPES TO SATISFY TYPE B, PERFORMANCE REQUIREMENTS TO BS 5867 PART 2
S14	"FIRE DOOR KEEP LOCKED" 10mm LETTERS TO BOTH SIDES OF DOOR LEAF	ARTIFICIAL FOLIAGE AND DECORATIVE EFFECTS TO BE FIRE RETARDANT TO THE SATISFACTION OF THE FIRE AUTHORITY
S20	"FIRE ESCAPE KEEP CLEAR" 10mm LETTERS TO BOTH SIDES OF DOOR LEAF	
S22	"FIRE EXIT" 20 mm LETTERS	
S25	"PUSH BAR TO OPEN" 20mm LETTERS	
S26	DIRECTIONAL ARROW (GREEN)	
FRG	FIRE RESISTING GLAZED ELEMENT	
☒	AREA COVERED BY ESCAPE LIGHTING TO BS.5266/PART 1	
SD	AREA COVERED BY SMOKE DETECTORS	
HD	AREA COVERED BY HEAT DETECTORS	
☒	FIRE ALARM CALL POINT	
☐	FIRE ALARM CONTROL PANEL	
☒	FIRE BLANKET IN CONTAINER	
☒	CARBON DIOXIDE FIRE EXTINGUISHER	
☒	9 LITRE WATER EXTINGUISHER	
☒	DRY POWDER EXTINGUISHER	
☒	FOAM FIRE EXTINGUISHER	
☒	ALARM WARNING DEVICE	

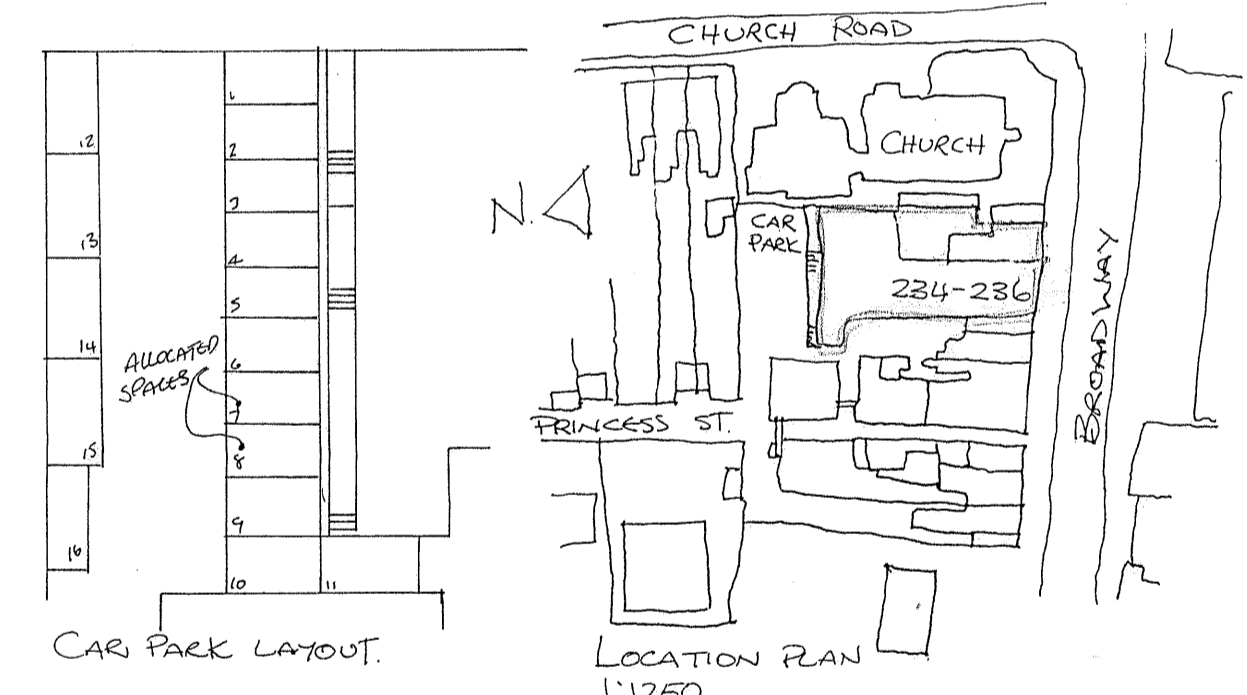

▨	AREA OF LICENSED PREMISES
▨	BAR/STAFF AREA
▨	LANDSCAPED AREA AND BAR GRATER
▨	OFFICE & STAFF AREA
▨	TILESET & PASSENGERS
▨	NO DRINKING AREA

REV. B: COLOUR TO LANDSCAPED AREA DELETED JAN '97  
REV. A: AMBIT EXTENDED TO INCLUDE LANDSCAPED AREA JAN '97

LAWRENCE TRING ARCHITECTS

TOWPATH HOUSE · LIMEHOUSE COURT · 3-11 DOD STREET  
LONDON E14 7EQ · TEL 0171 515 5100 · FAX 0171 538 4442

Project  
**WRONG-UN. THE BROADWAY**  
BEXLEY HEATH  
Client  
**J.D. WETHERSPOON P.L.C.**

Drawing  
**APPROVED AND PROPOSED LICENCE PLANS**

Scale 1:100 Drawn by  
Dwng. No. 394A/L01<sup>B</sup> Date DEC '96

APPROVED on behalf of the licensing Justices this 9th day of January 1997  
*Carol Anne Bedford*  
Clerk to the Licensing Justices