

FLOOR PLAN

41,237 SQ FT OF AVAILABLE OFFICE SPACE

Offering a total of 41,237 sq ft of office space across One Central Boulevard business are provided with with a unique opportunity to become part of the thriving Blythe Valley Park community. At the heart of this dynamic business hub is a versatile working environment with ample space making it the ideal setting for businesses to grow and thrive.

Plans not to scale. For identification purposes only.

17,810 SQ FT
GROUND FLOOR OFFICE SUITE

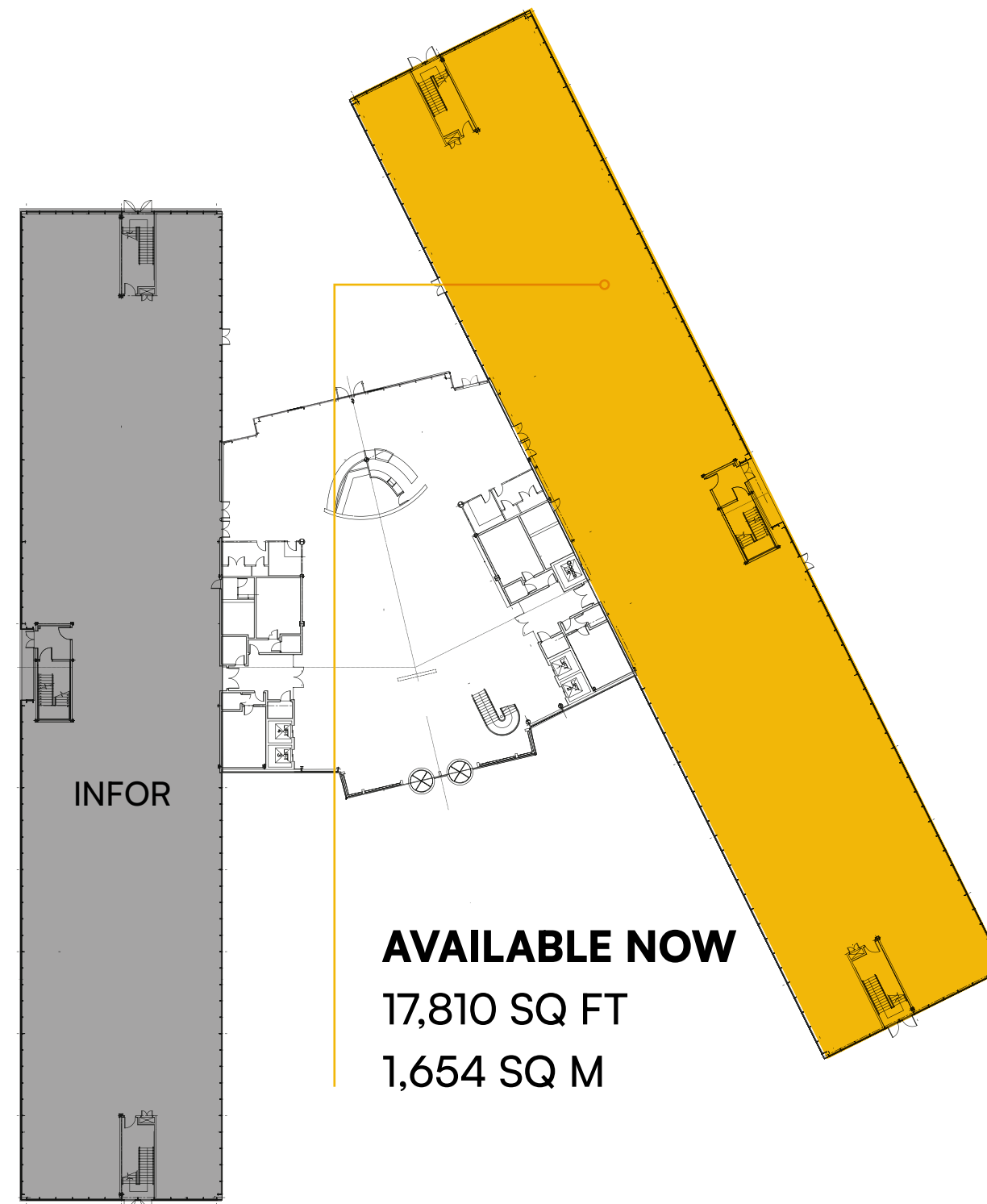

23,500 SQ FT
FIRST FLOOR OFFICE SUITE

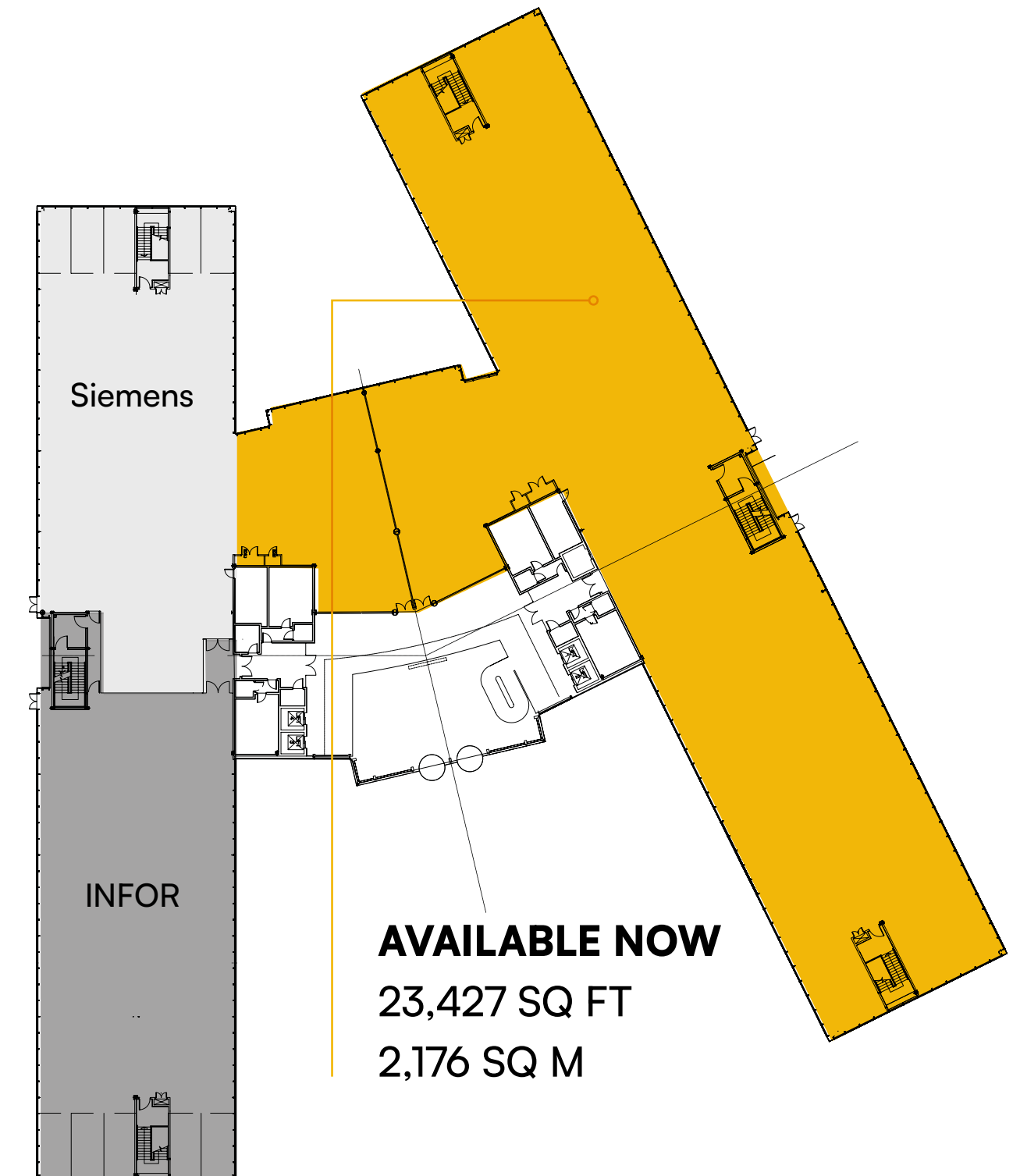

ONE CENTRAL BOULEVARD