

North Elevation 1:50



South Elevation 1:100

- Key -
- 1 Patinated zinc standin seam cladding - dark grey.
  - 2 Dark grey single ply flat roofing membrane.
  - 3 Patinated zinc formed square fascia's and soffits.
  - 4 Dark stain horizontal timber slot cladding to specialist detail.
  - 5 2No. fully glazed timber 'double glazed' door and frame with dark stain finish to be set within new opening.
  - 6 Toughened glazed guarding, fixed to inner face of parapet wall, 1100mm high off timber deck.
  - 7 Black aluminium 'Heritage style' rainwater hopper & down pipes

**COPYRIGHT**  
 A7 Design Limited DO NOT GIVE CONSENT to photograph, photocopy or copy by any other means. The content included within this drawing whether in full or in part without a separate permission from the author. In accordance with the copyright (Berwick of Guernsey) Ordinance, 2005 - The copyright of ALL information remains the intellectual property of A7 Design Limited.

**NOTES**  
 Figured dimensions are to be used in preference to scaled dimensions. Developers / Contractors MUST CHECK ALL dimensions and levels on site and any discrepancies must be reported to A7 Design Limited. If in doubt consult A7 Design Limited.

**AMENDMENTS**  
 A - 07/07/20 - GWH - Various revisions as requested by Building Control highlighted in red.  
 B - 14/07/20 - GWH - Additional information added in regards to Fire Safety as requested by Building Control  
 C - 04/08/20 - GWH - Dry Riser Added.



Location Plan 1:2500  
 Copyright 2019 State of Guernsey/Digmap Ltd  
 Digmap Science No.109

This drawing has been produced from information supplied by Others. Contractor must check all dimensions on site as required.

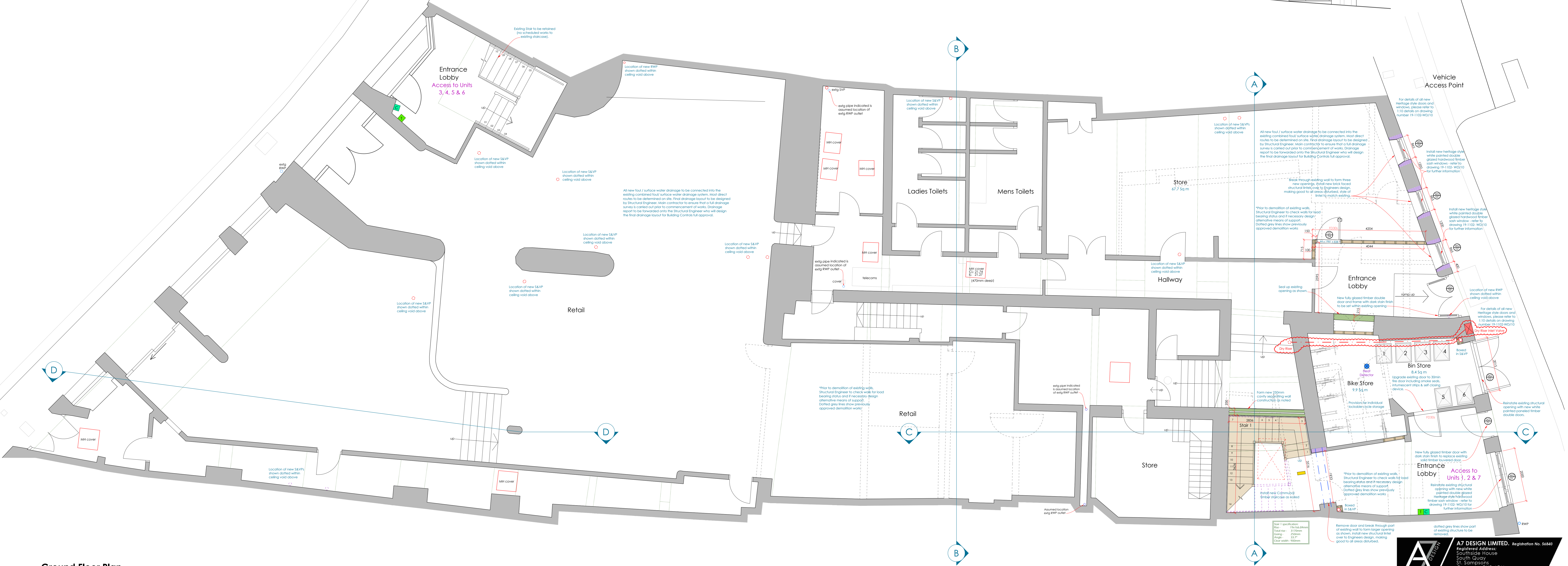

Ground Floor Plan 1:50

**Fire Alarm System Key:**

	Heat Detector (Dwelling Fire Alarm System - Grade D2 LD1 system to be installed, with beacons included).
	Smoke Alarm (Dwelling Fire Alarm System - Grade D2 LD1 system to be installed, with beacons included).
	Heat Detector (Communal Fire Alarm System - Grade D2 L2 system to be installed, allow for additional heat detector to dwelling protected halls).
	Smoke Alarm (Communal Fire Alarm System - Grade D2 L2 system to be installed, allow for additional heat detector to dwelling protected halls).
	Wall mounted fire alarm break glass call point.
	High level wall mounted fire alarm and ADW test control switch & alarm silence.
	Emergency bulkhead light fitting with battery backup & test key switch located remotely.
	Apoll fence fire alarm siren linked to communal fire alarm call points.

Fire alarm system equipment on drawings will be designed to a standard. A7 Design Limited do not accept design liability for the alarm & emergency lighting systems.

**A7 DESIGN LIMITED** - Registration No. 56860  
 Registered Address:  
 South Hill House  
 31 Compans Road  
 Guernsey GY2 4QH  
 WWW.A7DESIGN.CO.UK 01481 248330 admin@a7design.co.uk

**Project Description**  
 Proposed Residential Development to Create 7 Units of Accommodation

**Site Location**  
 Nelson Place  
 St. Peter Port  
 Guernsey, GY1 2JG

**Client**  
 Nelson Place Limited

**Drawing Status**  
 For Approval

**Drawing Title**  
 Ground Floor Plan & Elevations

**Client Ref.** 19-1102  
**Drawing Ref.** WD/01  
**Revision** C

**Cadastre Ref.** A113480000  
**Drawn By** G. Holt  
**Date** May 2020  
**Scale** 1:50  
**Drawing Type** Detailed