

TO LET - OFFICE

# ADELAIDE HOUSE

King William Street, EC4R 9HN



## Key Highlights

- 38,265 to 129,693 sq ft
- New L9 communal terrace
- Targeting BREEAM 'Excellent', Well 'Gold', Wirescore 'Platinum', EPC 'A'
- Building App
- Comprehensively refurbished
- New openable windows
- Extensive end of trip facility

SAVILLS City  
15 Finsbury Circus  
London EC2M 7EB  
**020 7499 8644**  
[savills.co.uk](https://www.savills.co.uk)



## Description

Adelaide house was developed in 1925 as the first steel framed building in the city. The Grade II building is now undergoing comprehensive refurbishment to provide iconic riverside workspace with spectacular views across the city and river. It's occupiers will also enjoy outstanding terraces with best in class amenity on both river and roof level.

## Location

Adelaide house is located on the north eastern side of London Bridge, to the south of Lower Thames Street. The location benefits from excellent transport links through; London Bridge, Monument, Bank, London Bridge, Cannon Street, Tower Hill and Fenchurch Street.

## Accommodation

The accommodation comprises the following areas:

Name	sq ft	sq m	Availability
8th	13,069	1,214.15	Coming Soon
7th	12,858	1,194.55	Coming Soon
6th	13,021	1,209.69	Coming Soon
5th	13,083	1,215.45	Coming Soon
4th	13,005	1,208.20	Coming Soon
3rd	13,167	1,223.25	Coming Soon
2nd	13,225	1,228.64	Coming Soon
1st	13,403	1,245.18	Coming Soon
Upper Ground	11,578	1,075.63	Coming Soon
Unit - River Level	13,284	1,234.12	Coming Soon
<b>Total</b>	<b>129,693</b>	<b>12,048.86</b>	

## Viewings

Strictly by appointment.

## Terms

A new lease from the Landlord for a term by arrangement.

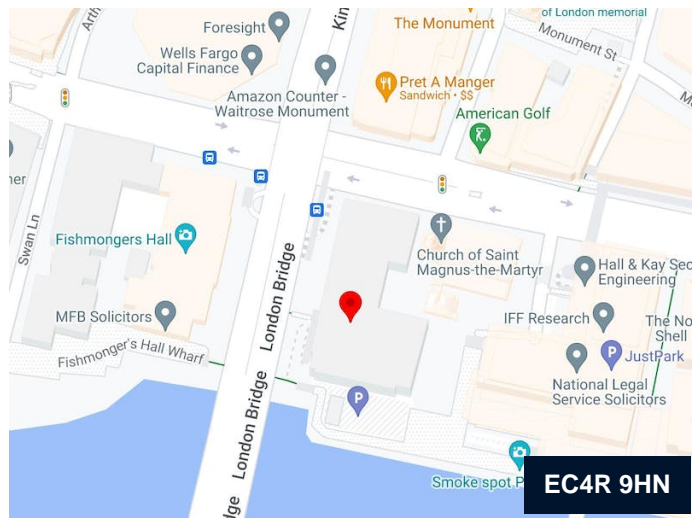
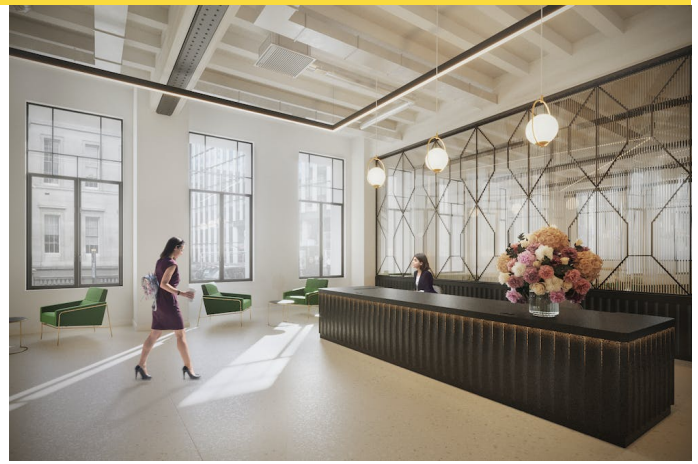

## Contact

### Jade Verona

0207 330 8617

0780 799 9783

jade.verona@savills.com

### Stuart Lawson

0207 499 8644

0787 055 5930

slawson@savills.com

### Brian Allen

020 7409 8778

07972 000 215

bmallen@savills.com

## IMPORTANT NOTICE

Savills, their clients and any joint agents give notice that: 1. They are not authorised to make or give any representations or warranties in relation to the property either here or elsewhere, either on their own behalf or on behalf of their client or otherwise. They assume no responsibility for any statement that may be made in these particulars. These particulars do not form part of any offer or contract and must not be relied upon as statements or representations of fact. 2. Any areas, measurements or distances are approximate. The text, photographs and plans are for guidance only and are not necessarily comprehensive. It should not be assumed that the property has all necessary planning, building regulation or other consents and Savills have not tested any services, equipment or facilities. Purchasers must satisfy themselves by inspection or otherwise. Generated by AgentsInsight / Generated on 05/10/2023

savills

