



To Dispose for Employment Use
Offices up to 200,000 sq ft

County Hall
Hertford

Hertford SG13 8DE

County Hall, Hertford, is an extensive site close to the town centre offering a wide range of letting options in various building types



Hertford Town Centre

Multi-storey
Car Park

County Suite

New Block

East Link

Register Office

Old Block

The site totals approximately 10.35 hectares / 25.59 acres

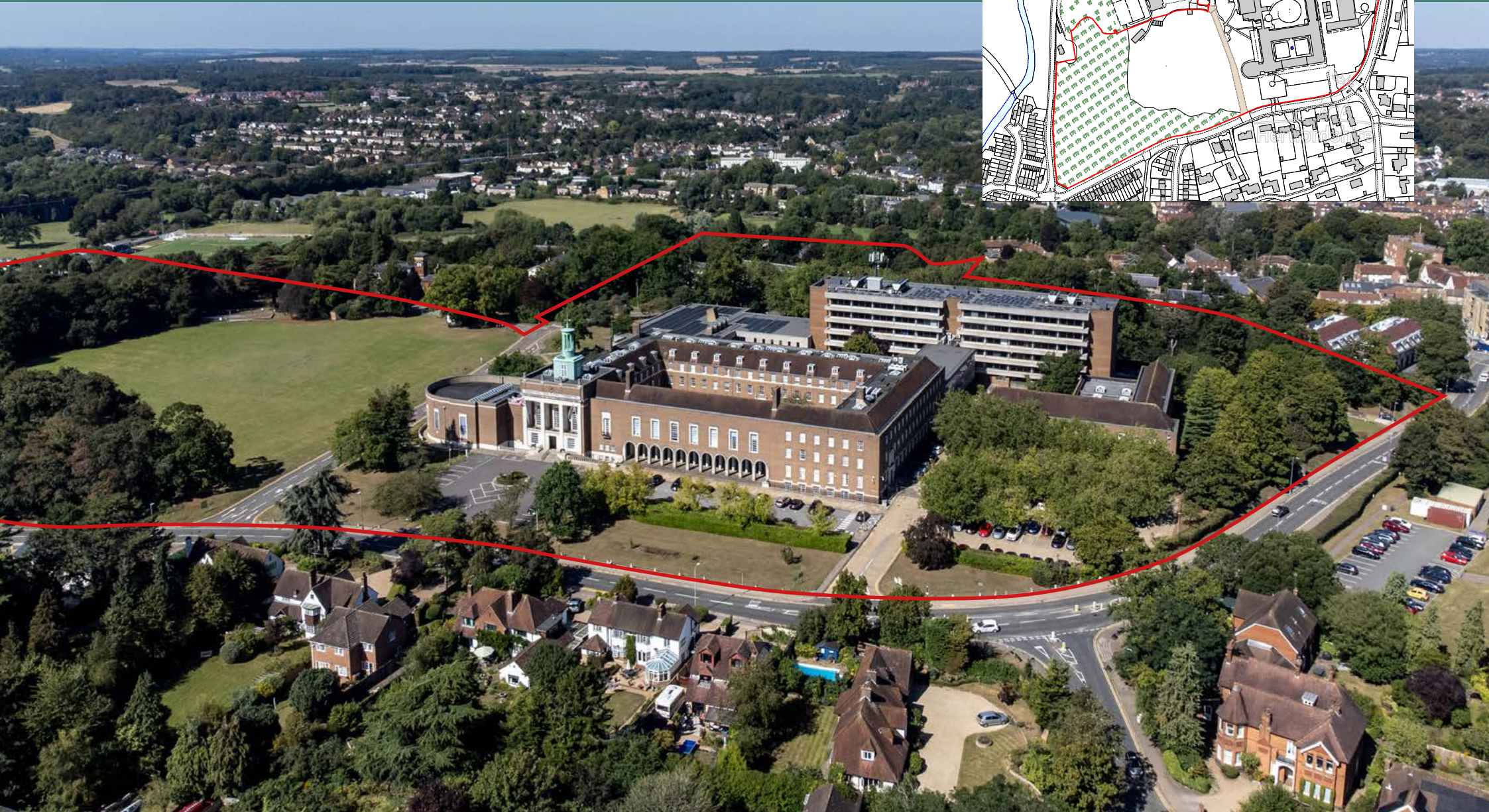
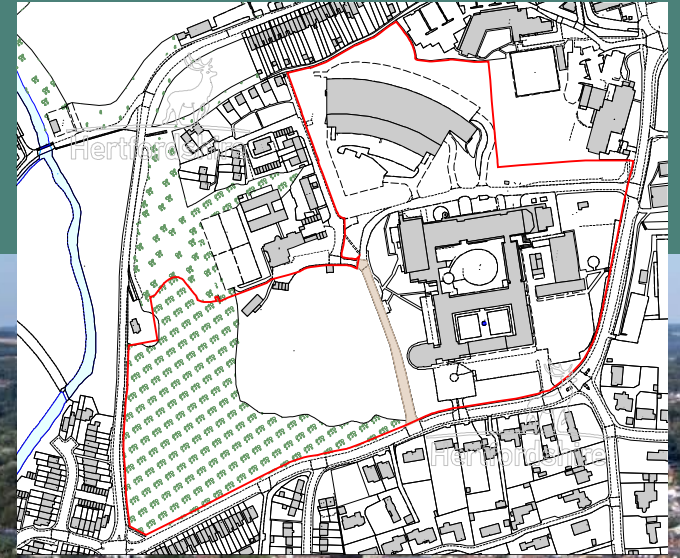

The original Grade II listed buildings were constructed in 1939, providing prestigious and historic office accommodation. The building was extended to provide modern office space, meeting rooms and canteen / restaurant in the 1970s.

Available for whole or part lettings up to 200,000 sq ft

Indicative combinations of spaces*

Option A	sq ft	sq m
Old Block	63,000	5,853

Option B	sq ft	sq m
New block	73,000	6,782
County Suite	27,000	2,508
East Link	13,000	1,208
Total	113,000	10,498

Option C	sq ft	sq m
Register Office	27,000	2,508

* The areas listed are on a net internal area basis.



Old Block



New Block



Register Office

Old Block

63,000 sq ft of prestigious office space to let

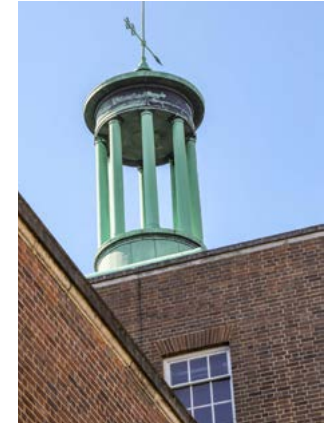

County Suite

27,000 sq ft of meeting rooms,
storage and canteen / restaurant



New Block

73,000 sq ft of modern office space

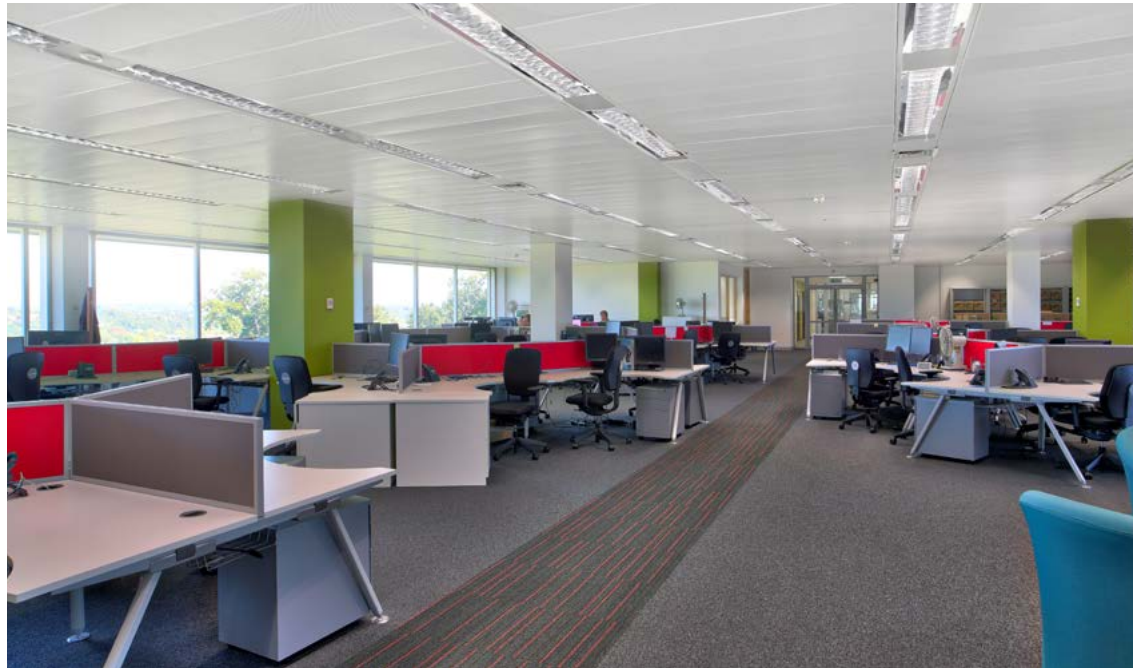

Typical New Block Floorplate

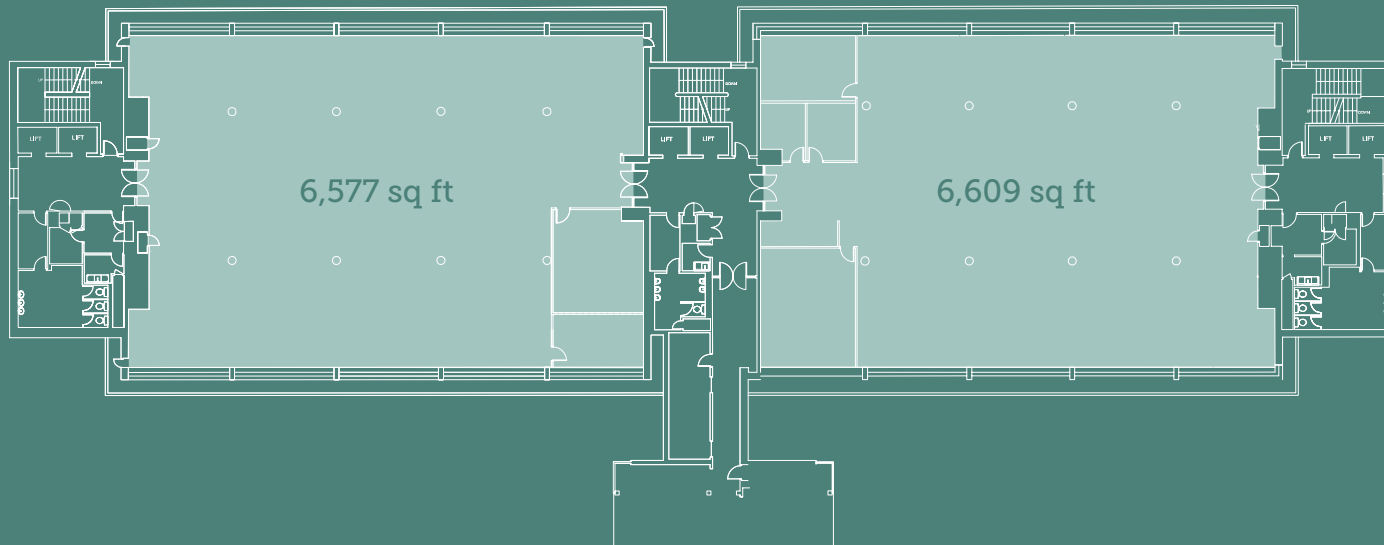

East Link

13,000 sq ft of office space
with views over landscaped
courtyard



Register Office

27,000 sq ft of prestigious office space
including meeting rooms

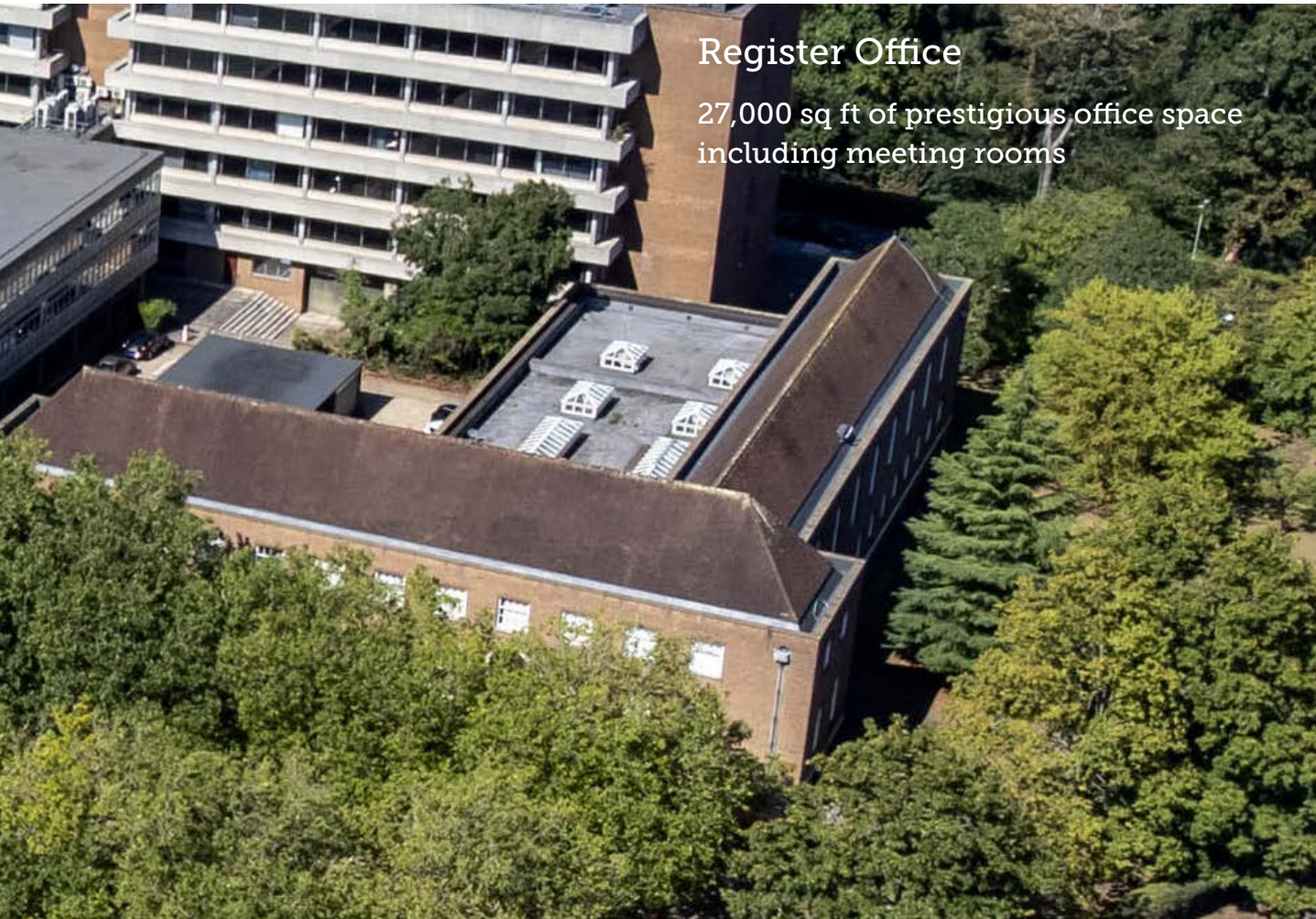

Multi-storey Car Park

Onsite parking for over 1,000 cars



Location

Hertford is a thriving, vibrant town. Its centre is home to an array of independent retailers, high street stores, delis, cafes and coffee shops. The area boasts a variety of sports facilities and places of historical interest to visit, all nestled in beautiful countryside just 20 miles from London.



Communications

Situated just 20 miles from London, Hertford has excellent transport links to London from its two stations with trains arriving from the capital every fifteen minutes.

Hertford East Station has a half hourly service from London Liverpool Street and Hertford North station is on the Letchworth Garden City line served from Moorgate with a journey time of approximately 40 minutes.

The town's bus station provides routes around Hertfordshire, to Harlow and Stansted (via Harlow) and Heathrow Airports.

By Rail	mins (fastest)
Hertford East Station	
Ware	4
Broxbourne	15
Cheshunt	19
Enfield Lock	24
Hackney Downs	41
London Liverpool Street	49

By Road	miles
Hertford North Station	
Cuffley	8
Stevenage	13
Enfield Chase	17
Alexandra Palace	28
Finsbury Park	36
Highbury & Islington	42
Old Street	48
London Moorgate	52

By Road	miles
Welwyn Garden City	7
Cheshunt	10
Tottenham	18
Luton Airport	19
Watford	21
Stansted	23
Central London	30
Chelmsford	30
Heathrow Airport	38

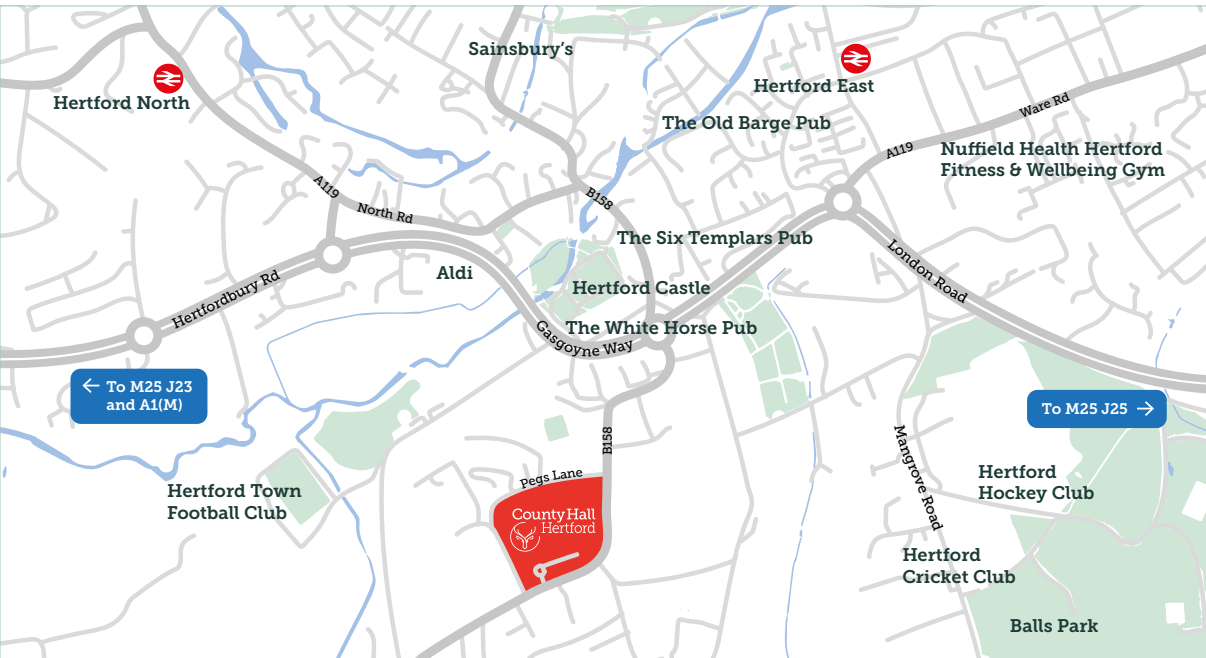

County Hall Hertford

Hertford SG13 8DE

EPC available on request.

Viewings strictly by appointment
with the sole agents

The Savills logo consists of the word "savills" in a lowercase, sans-serif font, colored red, set against a solid yellow square background.

Olivia Fryer

+44 (0) 20 7409 8708

+44 (0) 795 104 1788

olivia.fryer@savills.com

Andrew Willcock

+44 (0) 20 7409 8866

+44 (0) 787 099 9628

awillcock@savills.com

countyhallhertford.co.uk

MISREPRESENTATION ACT 1967

Savills hereby give notice that: (i) These particulars do not constitute any part of an offer or contract. (ii) Savills accept no legal responsibility for any statement or representation whether written, oral or implied or whether contained in any advertisement particulars or other matters issued by any correspondence entered into by them and whether made in any antecedent present or subsequent enquiries or negotiations. (iii) Neither Savills, their principals, agents, servants or representatives have any authority whatsoever to make or give any representation or warranty whatsoever whether written or implied in relation to this property. (iv) Any intending purchaser must satisfy himself by inspection or otherwise as to the correctness of any antecedent present or subsequent statements or representations, and should not rely upon the same unless he has satisfied himself accordingly. (v) Unless otherwise stated, all prices and rents are quoted exclusive of Value Added Tax (VAT). Any intending purchasers or lessees must satisfy themselves independently as to the incidence of VAT in respect of any transaction. Details updated November 2024.

