

# 1 KINGDOM STREET

Paddington Central, LONDON, W2.

## Sixth Floor Net Internal Area Plan

	OFFICE	2532.6 sq m	27261 sq ft
---	--------	-------------	-------------

**TOTAL AREA:**      **2532.6 sq m**      **27261 sq ft**

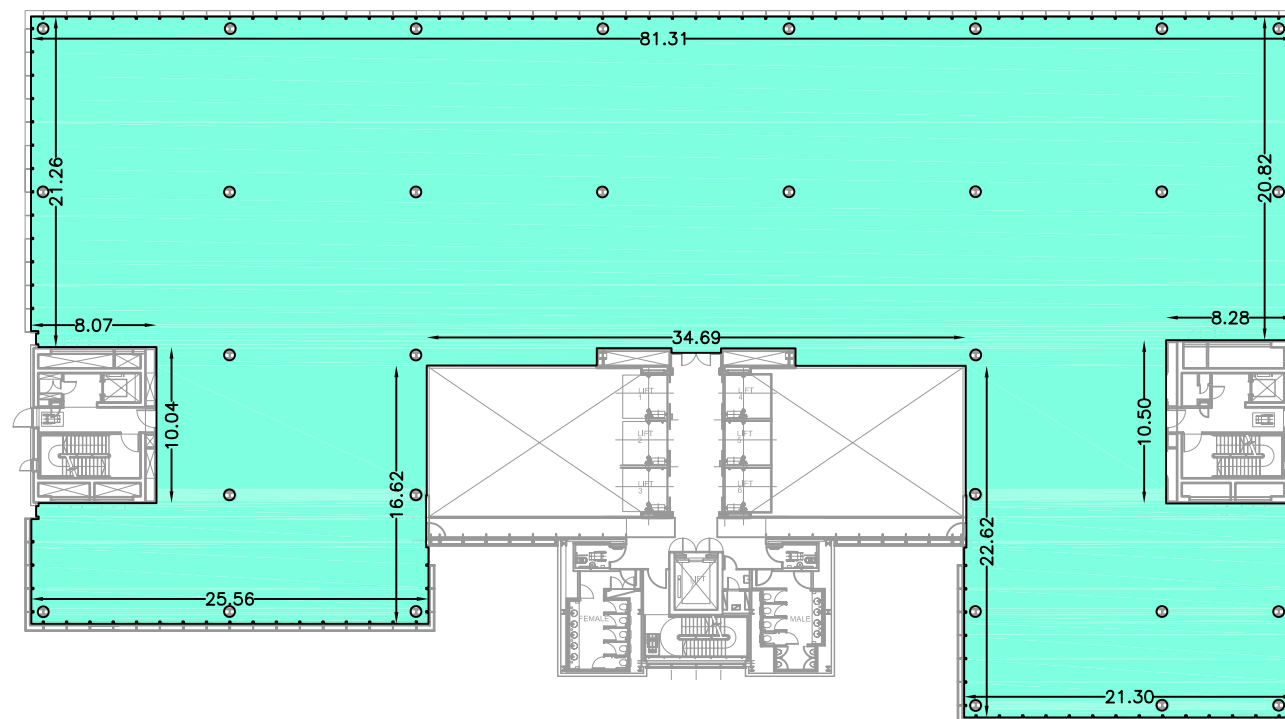

**Drawing No. 18400-001-A6**

Issue A April 2008

Scaled for presentation purposes

Condition of Site:  
Occupied  
**Vacant**  
Heavy Fit-Out  
Shell & Core  
**Under Construction**  
**Cat A Fit-Out**

Note.  
This drawing indicates the extent of the areas quoted, produced to an accuracy commensurate with standard presentation scales.  
It is held in a scaled digital CAD format.

Revisions:  
A - Original Issue (April 2008)  
B -  
C -  
D -  
E -  
F -

**Plowman Craven PCA**

**T** +44(0)1582 765566    **E** info@plowmancraven.co.uk  
**F** +44(0)1582 765370    **W** www.plowmancraven.co.uk