

Site Measurements not to be taken from drawings.
Contractor to confirm all dimensions.
HHD not liable for seeking relevant planning authority permissions (including LBC) unless specifically directed by the client

Note: HHD cannot accept responsibility for the accuracy of the NIA represented on these drawing as they are prepared from the base survey drawings provided by others

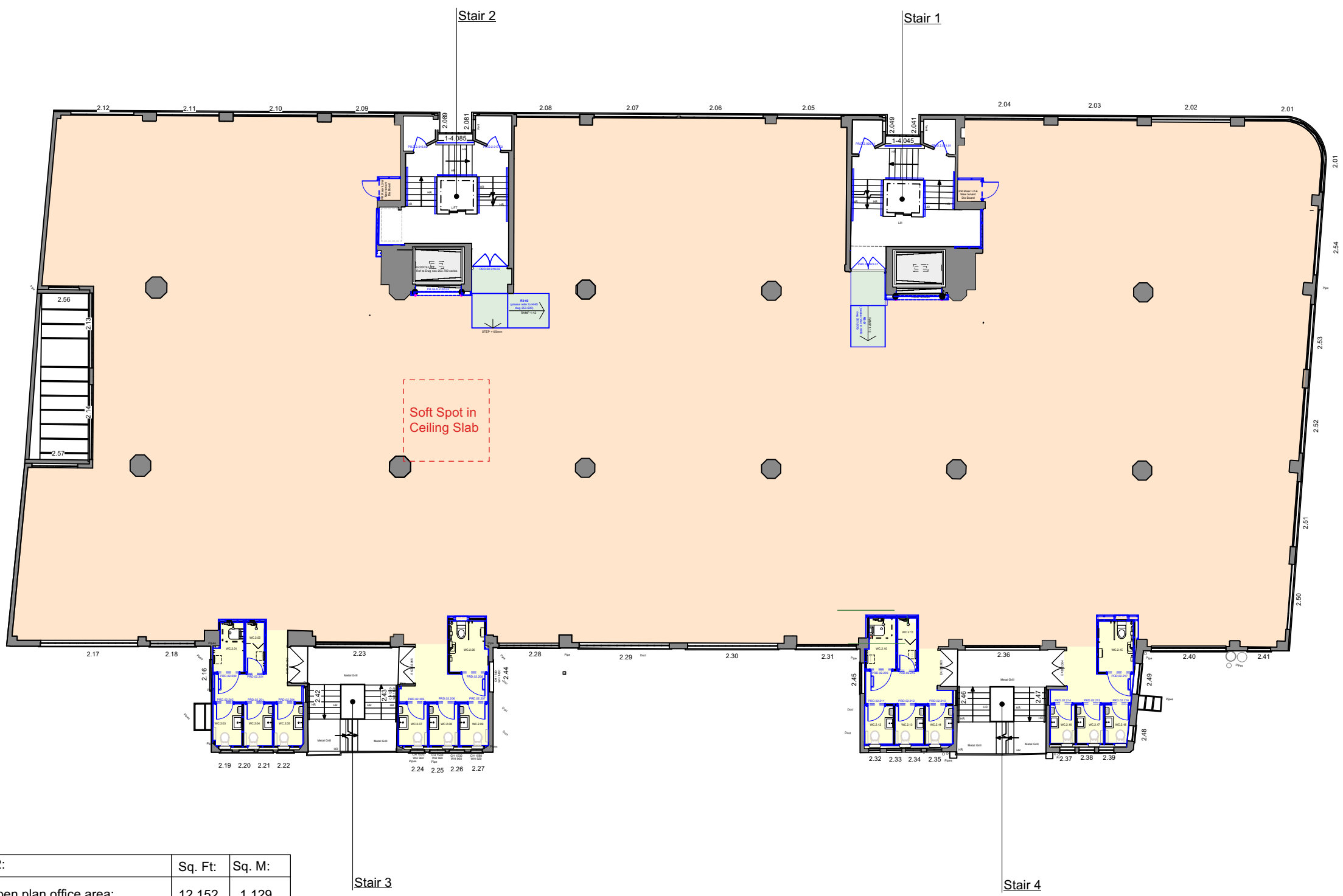

Key to Level 2:	Sq. Ft.	Sq. M:
NIA open plan office area:	12,152	1,129
NIA WC & Showers (inc circulation)	786.0	73.0
NIA Internal Ramps	127.7	11.87
TOTAL	13,065.7	1,213.87

NIA 2nd Floor GA
Shropshire House
1:200 @ A3

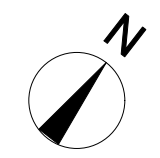

A 26/07/2023 L2 East Added
- 05/09.22 First Issue CMD

No.	Date	Revisions / Submissions	Revised by
-----	------	-------------------------	------------



Design Firm
HamburyHird Design Ltd.
50-52 Wellsway
Bath
BA2 4SA
Telephone: 01225 336004

Stage
CONSTRUCTION

Project Title
Shropshire House
11-20 Capper Street
London.WC1E 6JA

Drawing Title
NIA 2nd Floor GA

Project Manager RH	Project ID 253
Drawn By CMD	CAD File Name 253.102(G) Proposed 2nd Floor Series- Shropshire House.vwx
Reviewed By RH	Drawing No. 253.102.10(A)
Date Feb 23	
Scale 1:200 @ A3	