

Notes:
 Contractor must verify all dimensions on site before commencing any work or shop drawings. If this drawing exceeds the quantities taken in any way the Architects are to be informed before the work is initiated.
 Only figured dimensions to be taken from this drawing. Do not scale off this drawing. Drawings based on Ordnance Survey and / or existing record drawings - design and drawing content subject to Site Survey, Structural Survey, Site Investigation, Planning and Statutory Requirements and Approvals. Authorised reproduction from Ordnance Survey Map with permission of the Controller of Her Majesty's Stationery Office. Crown Copyright reserved.

Location Plan:

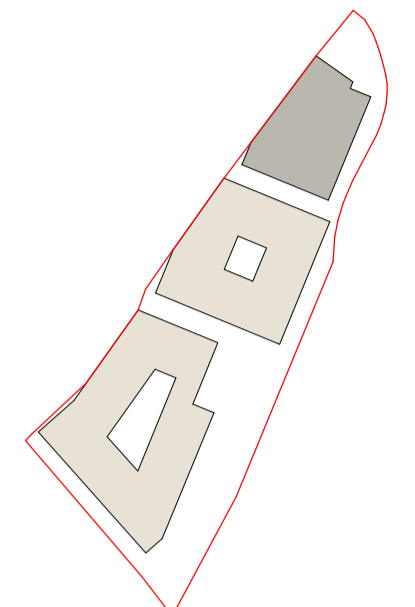

NOTES:
 Specialist facade & superstructure design in development. Facade zone indicative.

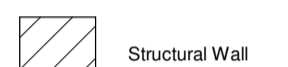

This drawing is to be read in conjunction with the following series drawings, schedules and reports;

- 1300 Fire Strategy Plans
 - 2600 GA Sections
 - 2700 GA Elevations
 - 3200 External Wall Details
 - 3400 Roof Details
 - 3800 Plant Screens
 - 4300 Internal Walls
 - 4400 Internal Doors
 - 9000 Internal Door Schedules
- Design Fire Consultant's 1315.2_R002.1 SHI MU2.2 & MU2.3-Stage 4 Fire Strategy Report_210927
- MEP Engineer's Information
 - Landscape Architect Information
 - Structural Engineer's Information

C03	Door Schedule Updates	LH	14/03/22	DP
C02	GA Updates	LH	11/02/22	ALL
C01	Issued For Construction	LH	06/08/21	RL
T04	Revised GA Information	AO	19/11/20	DT
T03	Design Freeze	AB	20/12/19	RG
T02	Facade Setting Out	AB	12/11/19	
T01	Preliminary tender issue for comment	AO	02/08/19	

Rev: Des: by: Date: Ch:

Client:
Vastint UK B.V.

Project:
Sugar House Island - MU2
 Title:
MU2.1 - First Floor GA Plan

Scale: Drawn by: Checked by: Date:
 As indicated @ A1 AXO RXG 17/07/19
 1:200 @ A3

Job No: Drawing No: Rev No:
 SHI CJCT MU2.1 ARC 01 DR 2001 C03

Carey Jones Chapman Tolcher
 Studio 104, 338 Goswell Road London EC1V 7LQ
 Tel +44(0)20 7269 9400 Fax +44(0)20 7269 9401
 www.cjctstudios.com
 Rose Wharf, East Street Leeds, LS9 8EE
 Tel +44(0)113 224 5000

Status: **Construction**

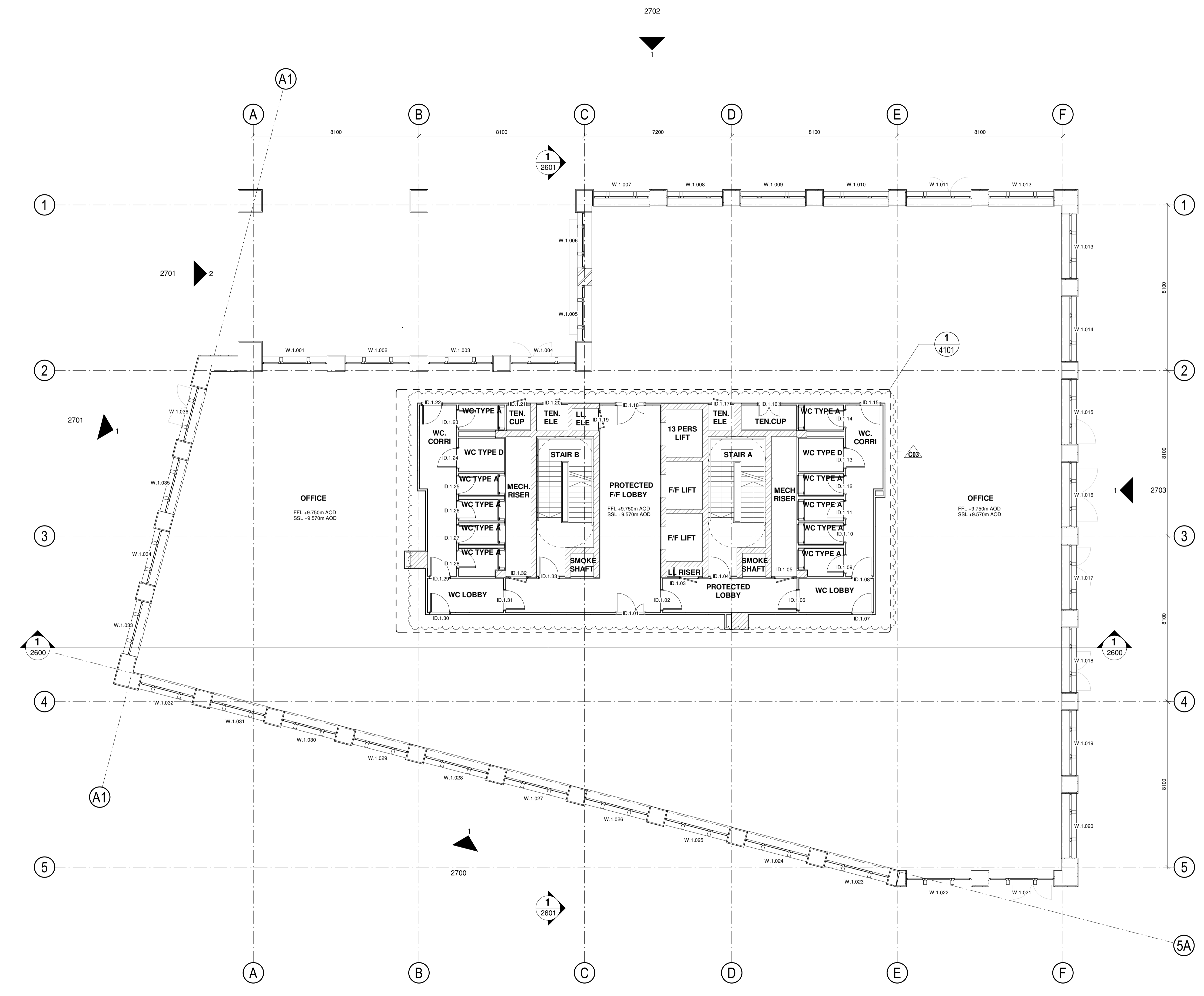

GA 01
 Scale - 1 : 100

